

- SIGNAGE LEGEND**
- S1 - SITE ID SIGN
  - S2A - MAJOR GATE ID SIGN  
 S2B - MINOR GATE ID SIGN
  - S3A - MAJOR WAYFINDING SIGN  
 S3B - MINOR WAYFINDING SIGN
  - S4 - ID LIGHTBOX SIGN
- NOTES:**
- REFER SIGNAGE CONTRACTORS DRAWINGS FOR SIGNAGE DETAILS
  - SIGNAGE SETOUTS SHOWN IN RED
  - SIGNAGE SETOUTS FROM CENTRELINE OF SIGNS

**CONSTRUCTION CERTIFICATE**  
 Approved Plans & Specifications relating to:  
 Date Approved: **10 July 2024**  
 Certificate No.: **CC - 2 4 0 8 1**  
**BLACKETT MAGUIRE + GOLDSMITH**

**FOR CONSTRUCTION**

17	ISSUE FOR COA	29/05/24	THESE DESIGN PLANS & SPECIFICATIONS AND THE COPYRIGHT THEREIN ARE THE PROPERTY OF THE ARCHITECT AND MUST NOT BE USED, REPRODUCED OR COPIED IN ANY MANNER WITHOUT THE WRITTEN PERMISSION OF THIS OFFICE.
16	ISSUED FOR CONSTRUCTION	13/05/24	
15	ISSUED FOR CONSTRUCTION	30/04/24	FIGURES DIMENSIONS TO BE USED IN REFERENCE TO SCALES ALL DIMENSIONS TO BE CHECKED ON SITE.
14	ISSUED FOR CONSTRUCTION	10/04/24	THIS DOCUMENT NOT TO BE USED FOR CONSTRUCTION UNLESS SIGNED & ISSUED FOR CONSTRUCTION.
13	ISSUED FOR CONSTRUCTION		
12	ISSUED FOR CONSTRUCTION		
11	ISSUED FOR CONSTRUCTION		
10	ISSUED FOR CONSTRUCTION		
9	ISSUED FOR CONSTRUCTION		
8	ISSUED FOR CONSTRUCTION		
7	ISSUED FOR CONSTRUCTION		
6	ISSUED FOR CONSTRUCTION		
5	ISSUED FOR CONSTRUCTION		
4	ISSUED FOR CONSTRUCTION		
3	ISSUED FOR CONSTRUCTION		
2	ISSUED FOR CONSTRUCTION		
1	ISSUED FOR CONSTRUCTION		
#	DESCRIPTION		

CC4 - Remaining fit-out, racking and hard stand of Warehouse 4C only

CLIENT		BUILDER		PROJECT NO.	23131
				TITLE	SITE PLAN
				DATE	29/05/24
				SCALE	As Indicated @ B1
				DRAWN	JA
				CHECKED	SI
				APPROVED	Approver
				DWG NO.	GA100
				REVISION	17





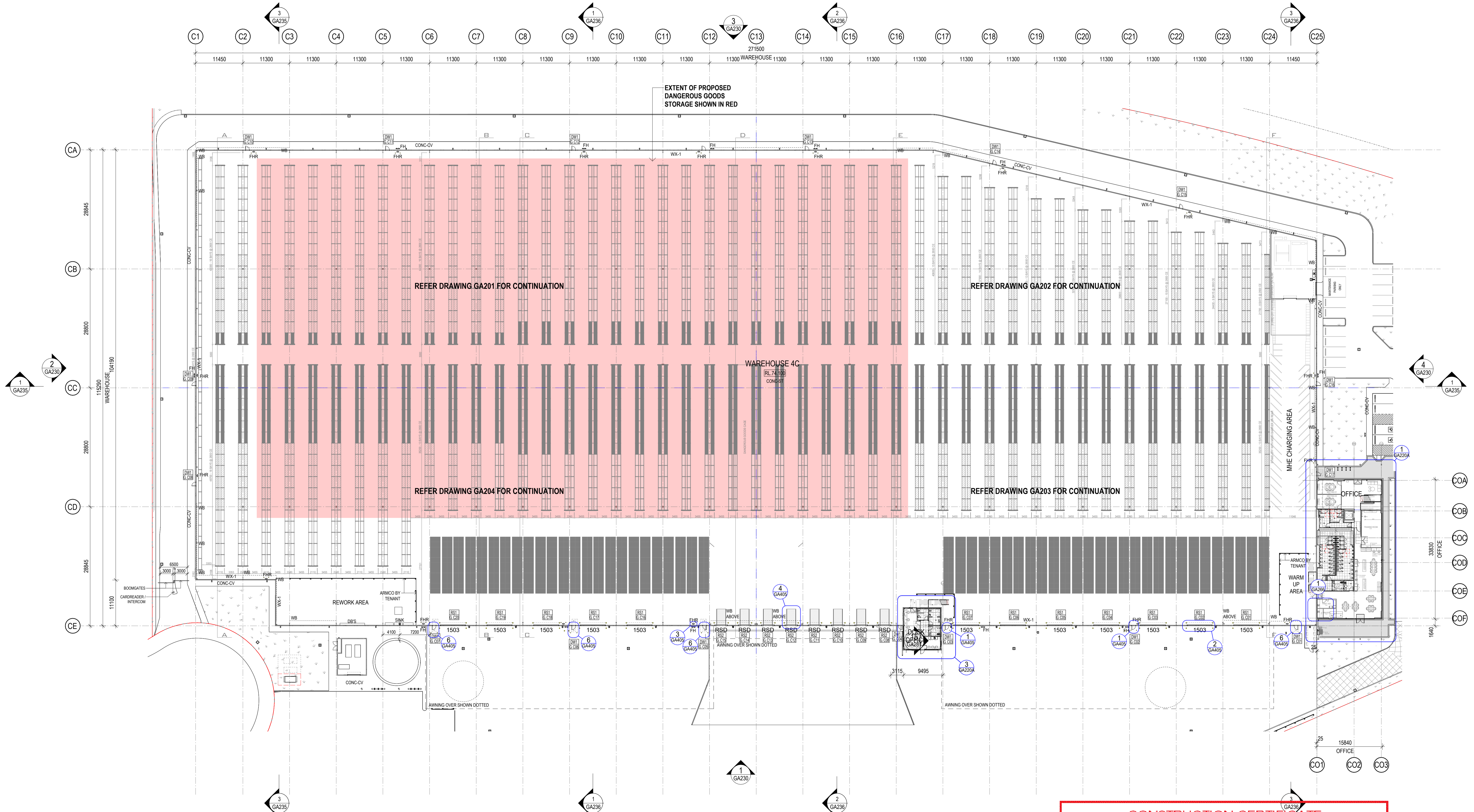

**CONSTRUCTION CERTIFICATE**  
 Approved Plans & Specifications relating to:  
 Date Approved: **10 July 2024**  
 Certificate No.: **C C - 2 4 0 8 1**  
**BLACKETT MAGUIRE + GOLDSMITH**

**FOR CONSTRUCTION**

9	ISSUE FOR COA	29/05/24	THESE DESIGN PLANS & SPECIFICATIONS AND THE COPYRIGHT THEREIN ARE THE PROPERTY OF THE ARCHITECT AND MUST NOT BE USED, REPRODUCED OR COPIED IN ANY MANNER WITHOUT THE WRITTEN PERMISSION OF THIS OFFICE.
8	ISSUED FOR CONSTRUCTION	13/05/24	
7	ISSUED FOR CONSTRUCTION	30/04/24	FIGURES DIMENSIONS TO BE USED IN PREFERENCE TO SCALING. ALL DIMENSIONS TO BE CHECKED ON SITE.
6	ISSUE FOR INFORMATION	09/04/24	THIS DOCUMENT NOT TO BE USED FOR CONSTRUCTION UNLESS SIGNED & ISSUED FOR CONSTRUCTION.
5	DESCRIPTION		

9	ISSUE FOR COA	29/05/24	THESE DESIGN PLANS & SPECIFICATIONS AND THE COPYRIGHT THEREIN ARE THE PROPERTY OF THE ARCHITECT AND MUST NOT BE USED, REPRODUCED OR COPIED IN ANY MANNER WITHOUT THE WRITTEN PERMISSION OF THIS OFFICE.
8	ISSUED FOR CONSTRUCTION	13/05/24	
7	ISSUED FOR CONSTRUCTION	30/04/24	FIGURES DIMENSIONS TO BE USED IN PREFERENCE TO SCALING. ALL DIMENSIONS TO BE CHECKED ON SITE.
6	ISSUE FOR INFORMATION	09/04/24	THIS DOCUMENT NOT TO BE USED FOR CONSTRUCTION UNLESS SIGNED & ISSUED FOR CONSTRUCTION.
5	DESCRIPTION		

9	ISSUE FOR COA	29/05/24	THESE DESIGN PLANS & SPECIFICATIONS AND THE COPYRIGHT THEREIN ARE THE PROPERTY OF THE ARCHITECT AND MUST NOT BE USED, REPRODUCED OR COPIED IN ANY MANNER WITHOUT THE WRITTEN PERMISSION OF THIS OFFICE.
8	ISSUED FOR CONSTRUCTION	13/05/24	
7	ISSUED FOR CONSTRUCTION	30/04/24	FIGURES DIMENSIONS TO BE USED IN PREFERENCE TO SCALING. ALL DIMENSIONS TO BE CHECKED ON SITE.
6	ISSUE FOR INFORMATION	09/04/24	THIS DOCUMENT NOT TO BE USED FOR CONSTRUCTION UNLESS SIGNED & ISSUED FOR CONSTRUCTION.
5	DESCRIPTION		

9	ISSUE FOR COA	29/05/24	THESE DESIGN PLANS & SPECIFICATIONS AND THE COPYRIGHT THEREIN ARE THE PROPERTY OF THE ARCHITECT AND MUST NOT BE USED, REPRODUCED OR COPIED IN ANY MANNER WITHOUT THE WRITTEN PERMISSION OF THIS OFFICE.
8	ISSUED FOR CONSTRUCTION	13/05/24	
7	ISSUED FOR CONSTRUCTION	30/04/24	FIGURES DIMENSIONS TO BE USED IN PREFERENCE TO SCALING. ALL DIMENSIONS TO BE CHECKED ON SITE.
6	ISSUE FOR INFORMATION	09/04/24	THIS DOCUMENT NOT TO BE USED FOR CONSTRUCTION UNLESS SIGNED & ISSUED FOR CONSTRUCTION.
5	DESCRIPTION		

9	ISSUE FOR COA	29/05/24	THESE DESIGN PLANS & SPECIFICATIONS AND THE COPYRIGHT THEREIN ARE THE PROPERTY OF THE ARCHITECT AND MUST NOT BE USED, REPRODUCED OR COPIED IN ANY MANNER WITHOUT THE WRITTEN PERMISSION OF THIS OFFICE.
8	ISSUED FOR CONSTRUCTION	13/05/24	
7	ISSUED FOR CONSTRUCTION	30/04/24	FIGURES DIMENSIONS TO BE USED IN PREFERENCE TO SCALING. ALL DIMENSIONS TO BE CHECKED ON SITE.
6	ISSUE FOR INFORMATION	09/04/24	THIS DOCUMENT NOT TO BE USED FOR CONSTRUCTION UNLESS SIGNED & ISSUED FOR CONSTRUCTION.
5	DESCRIPTION		

9	ISSUE FOR COA	29/05/24	THESE DESIGN PLANS & SPECIFICATIONS AND THE COPYRIGHT THEREIN ARE THE PROPERTY OF THE ARCHITECT AND MUST NOT BE USED, REPRODUCED OR COPIED IN ANY MANNER WITHOUT THE WRITTEN PERMISSION OF THIS OFFICE.
8	ISSUED FOR CONSTRUCTION	13/05/24	
7	ISSUED FOR CONSTRUCTION	30/04/24	FIGURES DIMENSIONS TO BE USED IN PREFERENCE TO SCALING. ALL DIMENSIONS TO BE CHECKED ON SITE.
6	ISSUE FOR INFORMATION	09/04/24	THIS DOCUMENT NOT TO BE USED FOR CONSTRUCTION UNLESS SIGNED & ISSUED FOR CONSTRUCTION.
5	DESCRIPTION		

9	ISSUE FOR COA	29/05/24	THESE DESIGN PLANS & SPECIFICATIONS AND THE COPYRIGHT THEREIN ARE THE PROPERTY OF THE ARCHITECT AND MUST NOT BE USED, REPRODUCED OR COPIED IN ANY MANNER WITHOUT THE WRITTEN PERMISSION OF THIS OFFICE.
8	ISSUED FOR CONSTRUCTION	13/05/24	
7	ISSUED FOR CONSTRUCTION	30/04/24	FIGURES DIMENSIONS TO BE USED IN PREFERENCE TO SCALING. ALL DIMENSIONS TO BE CHECKED ON SITE.
6	ISSUE FOR INFORMATION	09/04/24	THIS DOCUMENT NOT TO BE USED FOR CONSTRUCTION UNLESS SIGNED & ISSUED FOR CONSTRUCTION.
5	DESCRIPTION		

9	ISSUE FOR COA	29/05/24	THESE DESIGN PLANS & SPECIFICATIONS AND THE COPYRIGHT THEREIN ARE THE PROPERTY OF THE ARCHITECT AND MUST NOT BE USED, REPRODUCED OR COPIED IN ANY MANNER WITHOUT THE WRITTEN PERMISSION OF THIS OFFICE.
8	ISSUED FOR CONSTRUCTION	13/05/24	
7	ISSUED FOR CONSTRUCTION	30/04/24	FIGURES DIMENSIONS TO BE USED IN PREFERENCE TO SCALING. ALL DIMENSIONS TO BE CHECKED ON SITE.
6	ISSUE FOR INFORMATION	09/04/24	THIS DOCUMENT NOT TO BE USED FOR CONSTRUCTION UNLESS SIGNED & ISSUED FOR CONSTRUCTION.
5	DESCRIPTION		

9	ISSUE FOR COA	29/05/24	THESE DESIGN PLANS & SPECIFICATIONS AND THE COPYRIGHT THEREIN ARE THE PROPERTY OF THE ARCHITECT AND MUST NOT BE USED, REPRODUCED OR COPIED IN ANY MANNER WITHOUT THE WRITTEN PERMISSION OF THIS OFFICE.
8	ISSUED FOR CONSTRUCTION	13/05/24	
7	ISSUED FOR CONSTRUCTION	30/04/24	FIGURES DIMENSIONS TO BE USED IN PREFERENCE TO SCALING. ALL DIMENSIONS TO BE CHECKED ON SITE.
6	ISSUE FOR INFORMATION	09/04/24	THIS DOCUMENT NOT TO BE USED FOR CONSTRUCTION UNLESS SIGNED & ISSUED FOR CONSTRUCTION.
5	DESCRIPTION		

9	ISSUE FOR COA	29/05/24	THESE DESIGN PLANS & SPECIFICATIONS AND THE COPYRIGHT THEREIN ARE THE PROPERTY OF THE ARCHITECT AND MUST NOT BE USED, REPRODUCED OR COPIED IN ANY MANNER WITHOUT THE WRITTEN PERMISSION OF THIS OFFICE.
8	ISSUED FOR CONSTRUCTION	13/05/24	
7	ISSUED FOR CONSTRUCTION	30/04/24	FIGURES DIMENSIONS TO BE USED IN PREFERENCE TO SCALING. ALL DIMENSIONS TO BE CHECKED ON SITE.
6	ISSUE FOR INFORMATION	09/04/24	THIS DOCUMENT NOT TO BE USED FOR CONSTRUCTION UNLESS SIGNED & ISSUED FOR CONSTRUCTION.
5	DESCRIPTION		

CLIENT		BUILDER		DATE	29/05/24	PROJECT NO.	23131
				SCALE	1:400 @ B1		
				DRAWN	Author		
				CHECKED	Checker		
				APPROVED	Approver		
OAKDALE WEST -- LOTS 4C & 4D KEMPS CREEK, NSW				TITLE	4C WAREHOUSE FLOOR PLAN - OVERALL		
				DWG NO.	GA200		
				REVISION	9		



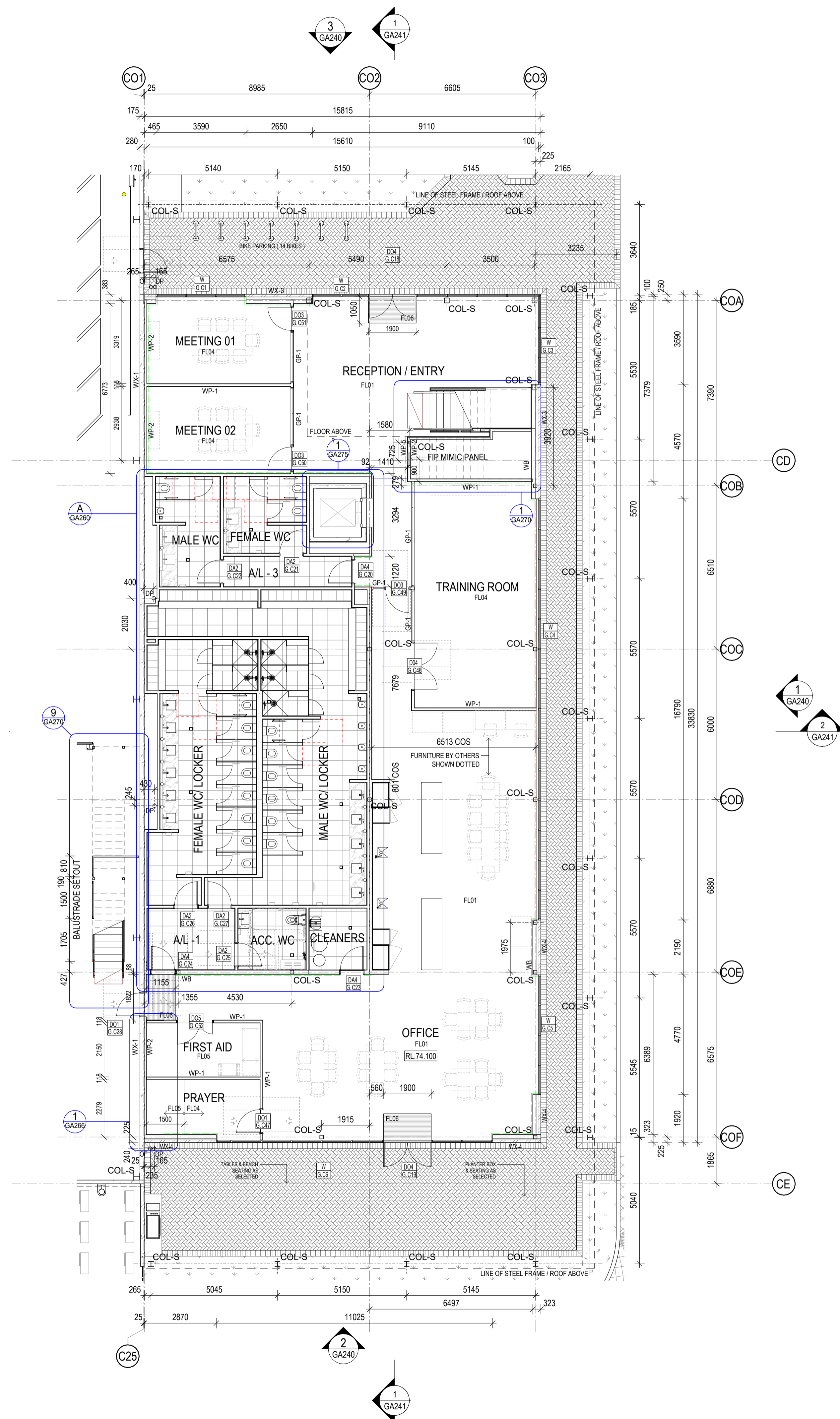

1 4C OFFICE FLOOR PLAN - GROUND 1 : 100

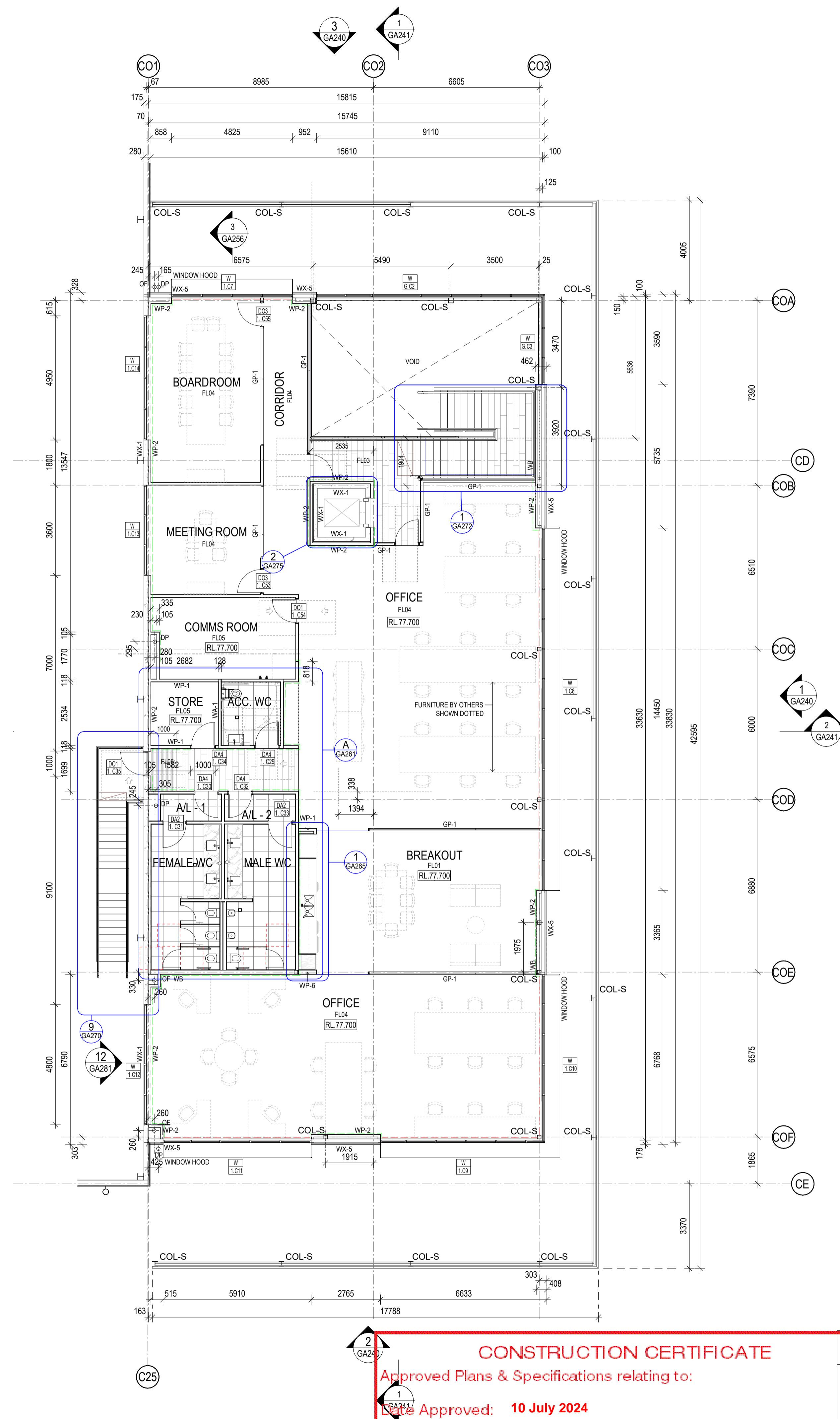

2 4C OFFICE FLOOR PLAN - LEVEL 1 1 : 100

**CONSTRUCTION CERTIFICATE**  
 Approved Plans & Specifications relating to:  
 1 Approved: **10 July 2024**  
 Certificate No.: **C C - 2 4 0 8 1**  
**BLACKETT MAGUIRE + GOLDSMITH**

SKIRTING LEGEND	
	SK01 - 150mm FLAT SKIRTING
	SK02 - 150mm DUCTED SKIRTING

**FOR CONSTRUCTION**

13	ISSUE FOR COA	29/05/24	THESE DESIGNS, PLANS & SPECIFICATIONS AND THE COPYRIGHT THEREIN ARE THE PROPERTY OF THE ARCHITECT AND MUST NOT BE USED, REPRODUCED OR COPIED IN ANY FORM OR BY ANY MEANS WITHOUT THE WRITTEN PERMISSION OF THIS OFFICE.
12	ISSUED FOR CONSTRUCTION	13/05/24	
11	ISSUED FOR CONSTRUCTION	29/04/24	FIGURES DIMENSIONS TO BE USED IN REFERENCE TO SCALES ALL DIMENSIONS TO BE CHECKED ON SITE.
10	ISSUED FOR CONSTRUCTION	23/04/24	THIS DOCUMENT NOT TO BE USED FOR CONSTRUCTION UNLESS SIGNED & ISSUED FOR CONSTRUCTION.
9	2.5m Fall Ramps		
8	DESCRIPTION		

CLIENT		BUILDER		OAKDALE WEST -- LOTS 4C & 4D KEMPS CREEK, NSW	DATE	29/05/24	PROJECT NO.	23131
				TITLE	SCALE	As Indicated @ B1		
					DRAWN	Author		
					CHECKED	Checker		
					APPROVED	Approver		
							DWG NO.	GA220
							REVISION	13

20/05/2024 10:16:38 AM



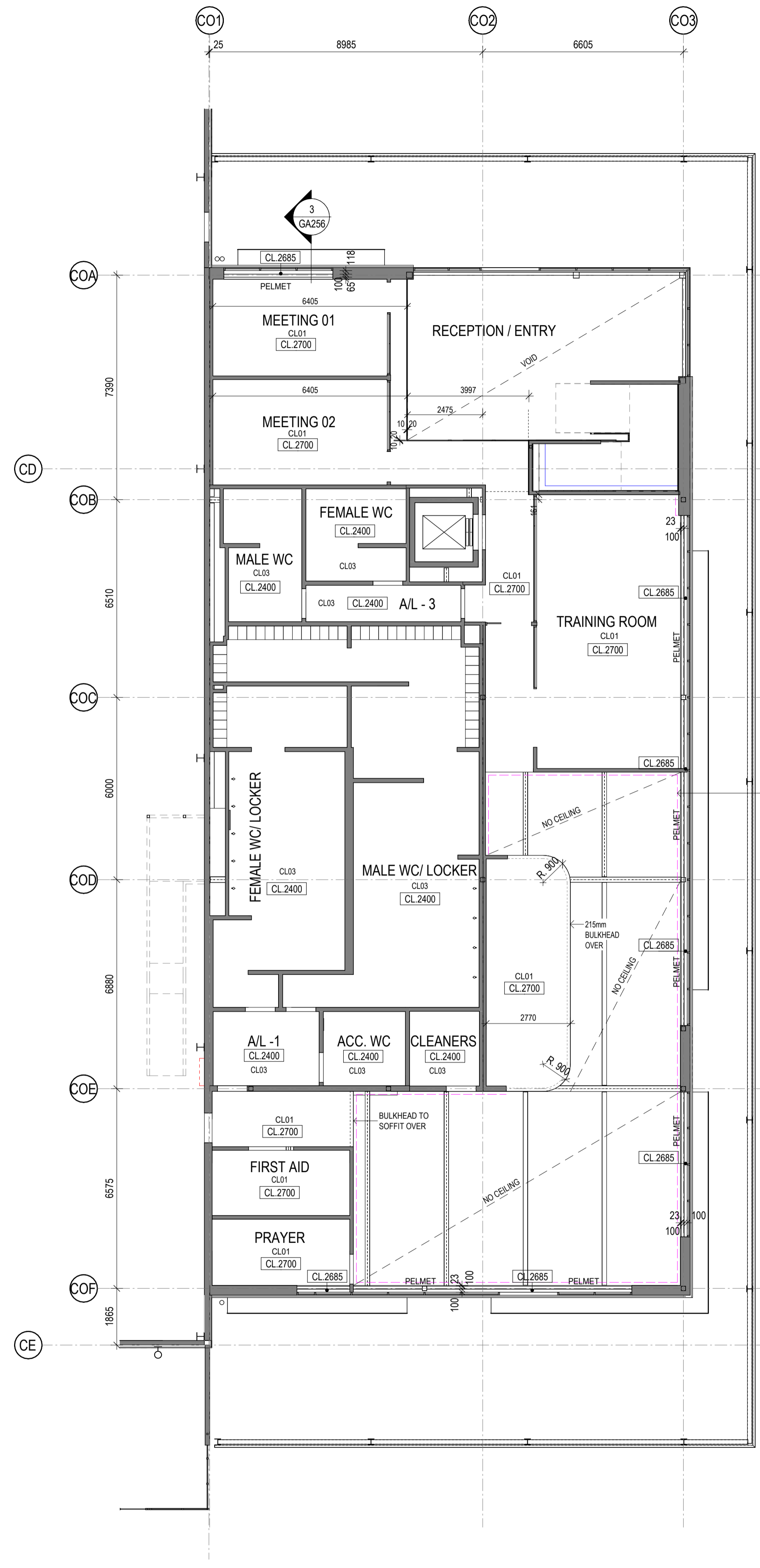

1 4C OFFICE RCP - GROUND FLOOR 1:100

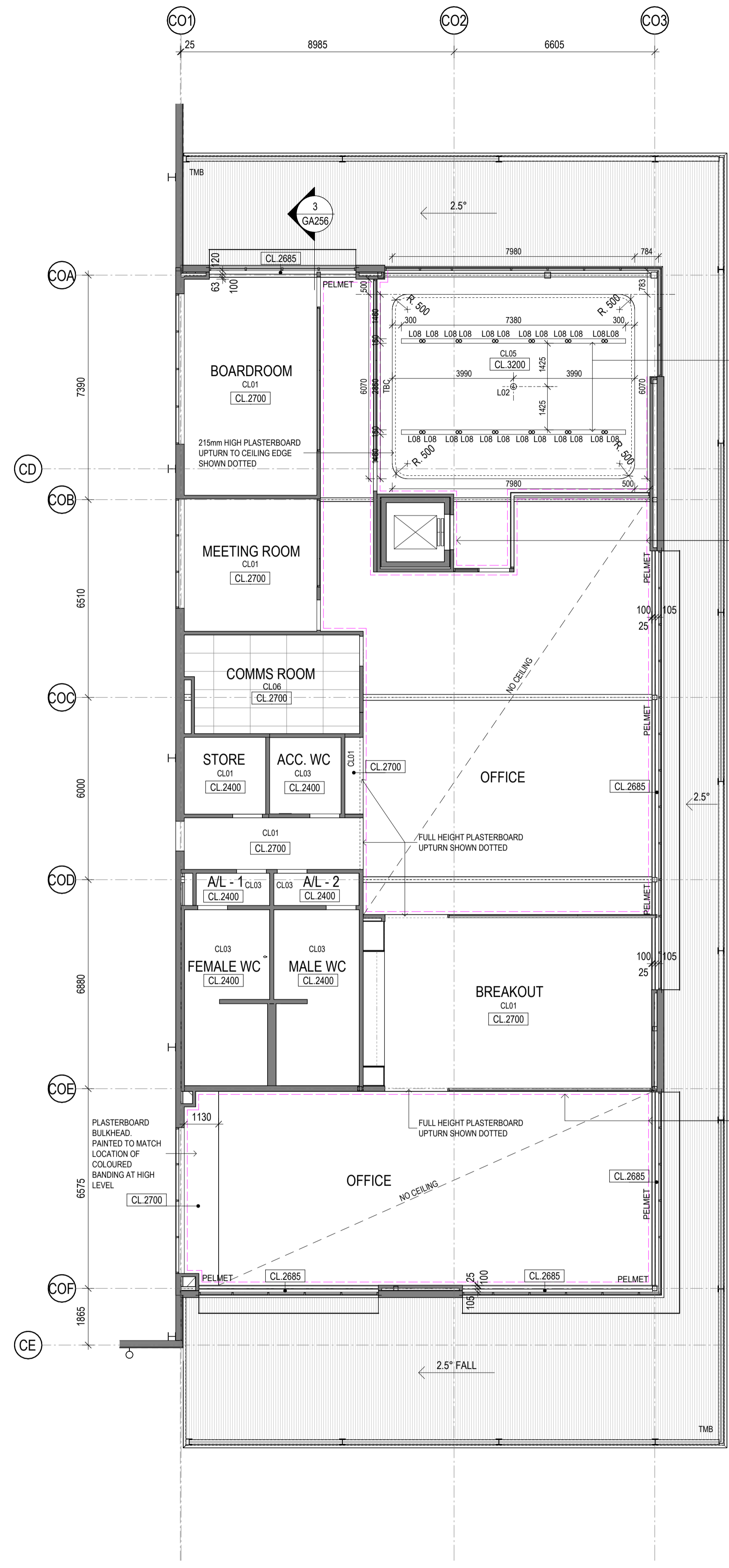

2 4C OFFICE RCP - LEVEL 1 1:100

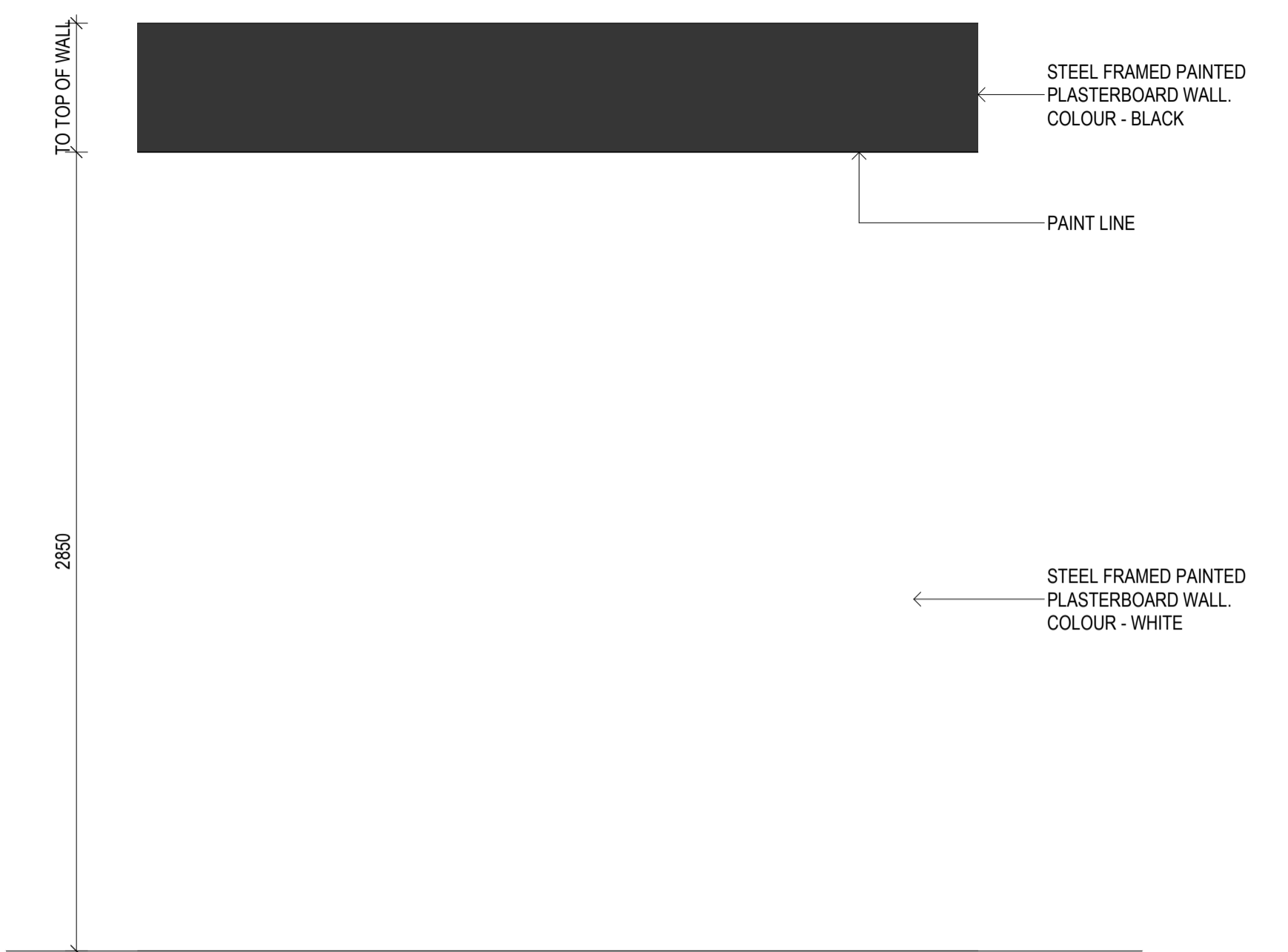

NOTE :  
VENTS / GRILLES AND SERVICES TO BE PLACED AT HIGH LEVEL WITHIN THE BLACK BAND WHERE POSSIBLE.  
WHERE NOT POSSIBLE GRILLES / VENTS AND SERVICES TO BE COORDINATED TO AVOID BEING PLACED HALFWAY BETWEEN THE BLACK AND WHITE PORTION OF THE WALL WHERE POSSIBLE.  
VENTS / GRILLES TO BE PAINTED TO MATCH THE CORRESPONDING WALL COLOUR.

3 4C OFFICE - WALL PAINT ELEVATION 1:20

**CONSTRUCTION CERTIFICATE**  
Approved Plans & Specifications relating to:  
Date Approved: **10 July 2024**  
Certificate No.: **CC - 24081**  
**BLACKETT MAGUIRE + GOLDSMITH**

**FOR CONSTRUCTION**

8	ISSUE FOR COCA	29/05/24	THESE DESIGN PLANS & SPECIFICATIONS AND THE COPYRIGHT THEREIN ARE THE PROPERTY OF THE ARCHITECT AND MUST NOT BE USED, REPRODUCED OR COPIED IN ANY MANNER WITHOUT THE WRITTEN PERMISSION OF THIS OFFICE.
7	ISSUED FOR CONSTRUCTION	13/05/24	
6	Change revised		
5	Final issue		
4	ISSUED FOR CONSTRUCTION	16/04/24	FIGURES DIMENSIONS TO BE USED IN PREFERENCE TO SCALING. ALL DIMENSIONS TO BE CHECKED ON SITE.
3	Bulkhead added		
2	ISSUED FOR CONSTRUCTION	08/05/24	THIS DOCUMENT NOT TO BE USED FOR CONSTRUCTION UNLESS SIGNED & ISSUED FOR CONSTRUCTION.
1	DESCRIPTION		

CLIENT		BUILDER		PROJECT NO.	23131
				TITLE	4C OFFICE REFLECTED CEILING PLAN
				DATE	29/05/24
				SCALE	As Indicated @ B1
				DRAWN	Author
				CHECKED	Checker
				APPROVED	Approver

CLIENT		BUILDER		PROJECT NO.	23131
				TITLE	4C OFFICE REFLECTED CEILING PLAN
				DATE	29/05/24
				SCALE	As Indicated @ B1
				DRAWN	Author
				CHECKED	Checker
				APPROVED	Approver



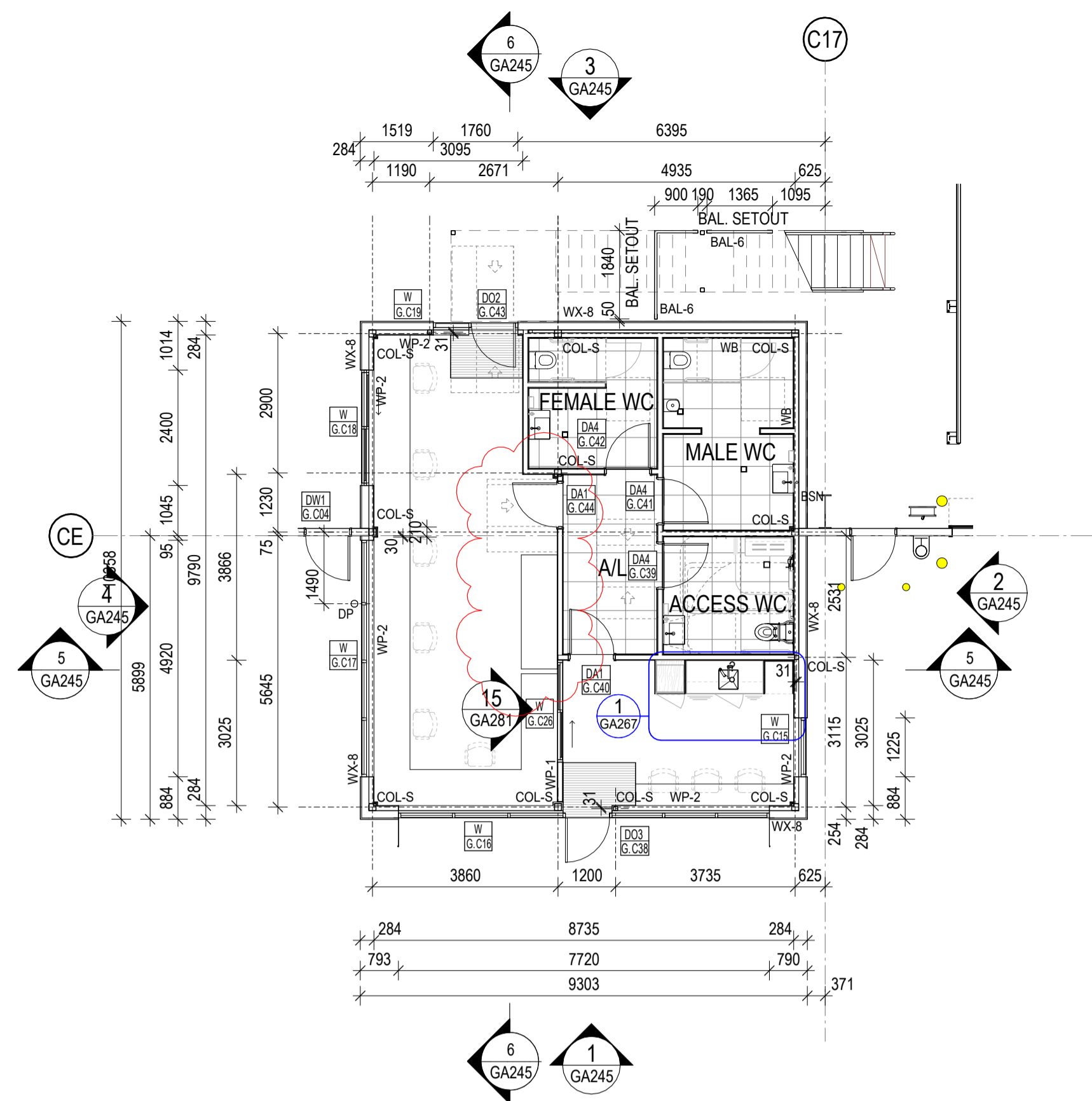

1 4C DOCK OFFICE FLOOR PLAN - GROUND 1 : 100

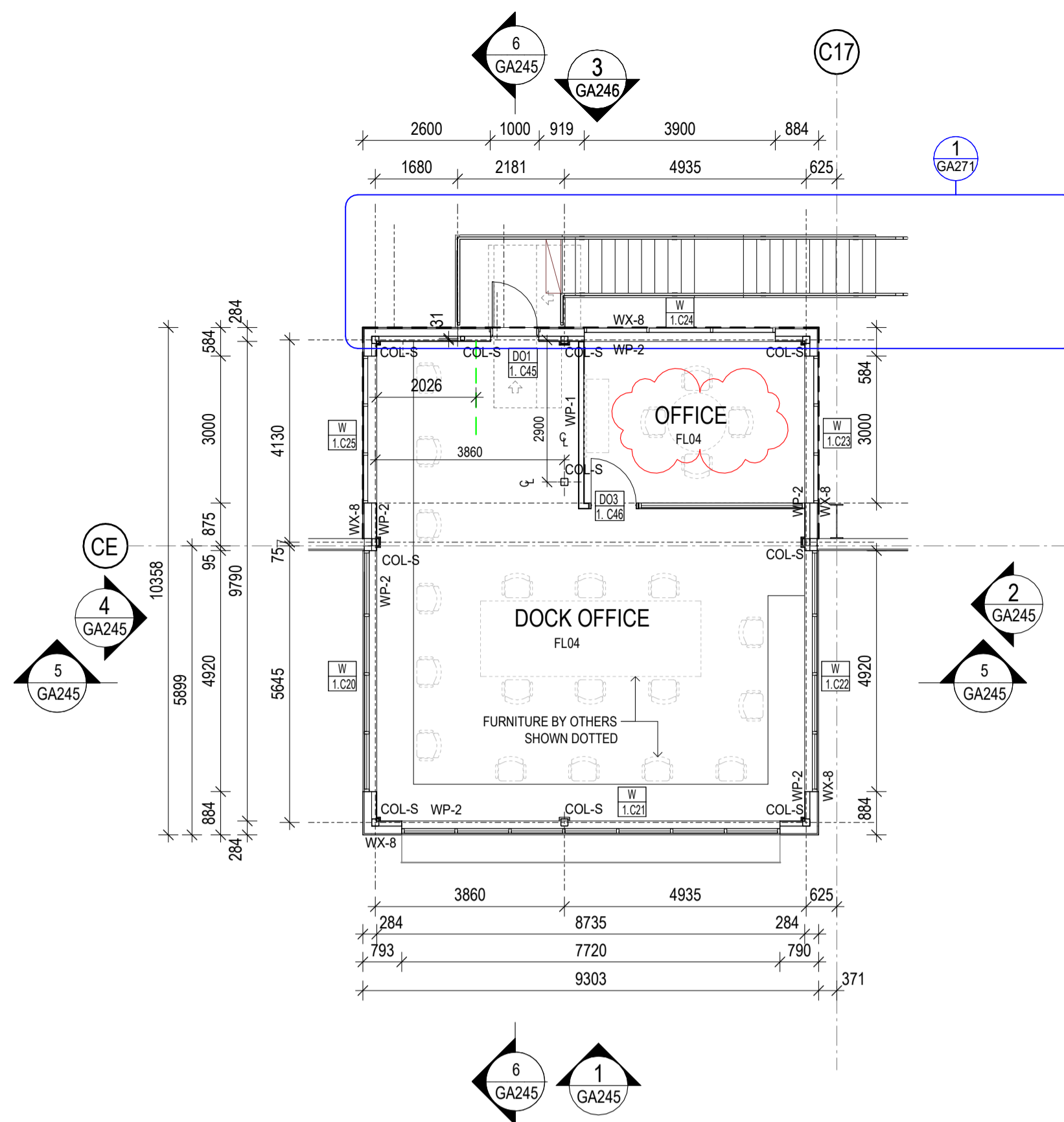

2 4C DOCK OFFICE FLOOR PLAN - LEVEL 1 1 : 100

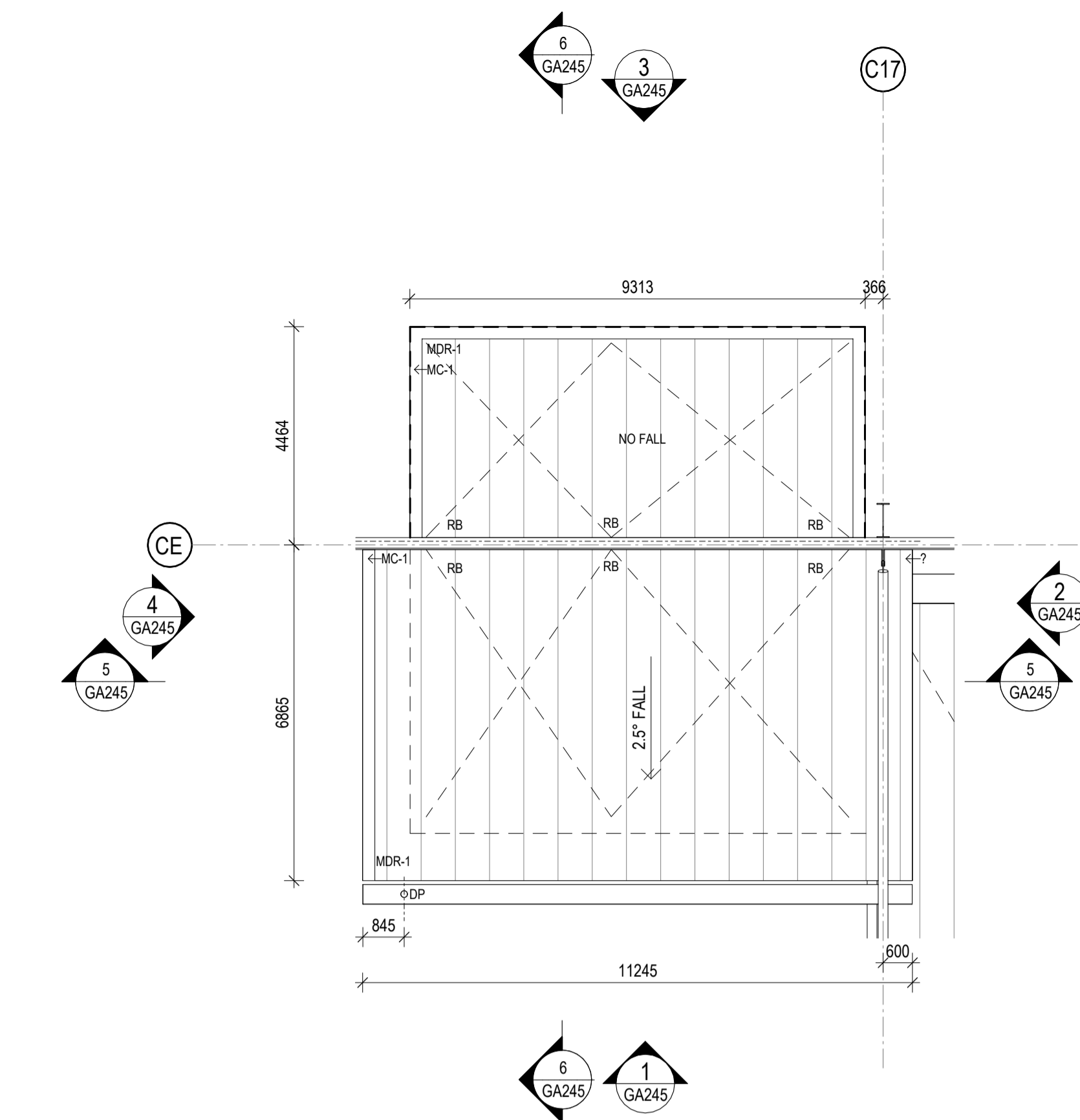

3 4C DOCK OFFICE ROOF PLAN 1 : 100

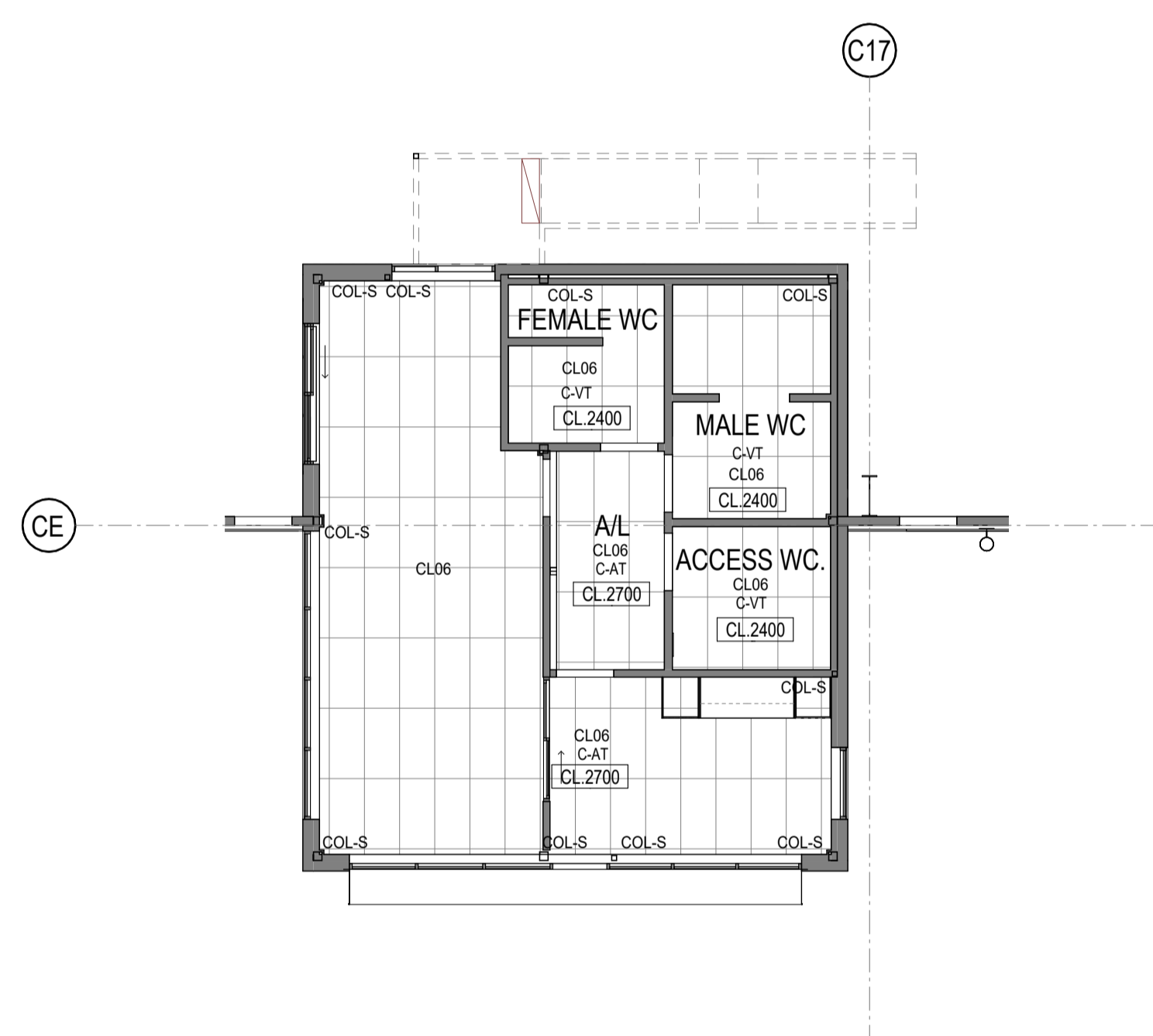

4 4C DOCK OFFICE RCP - GROUND FLOOR 1 : 100

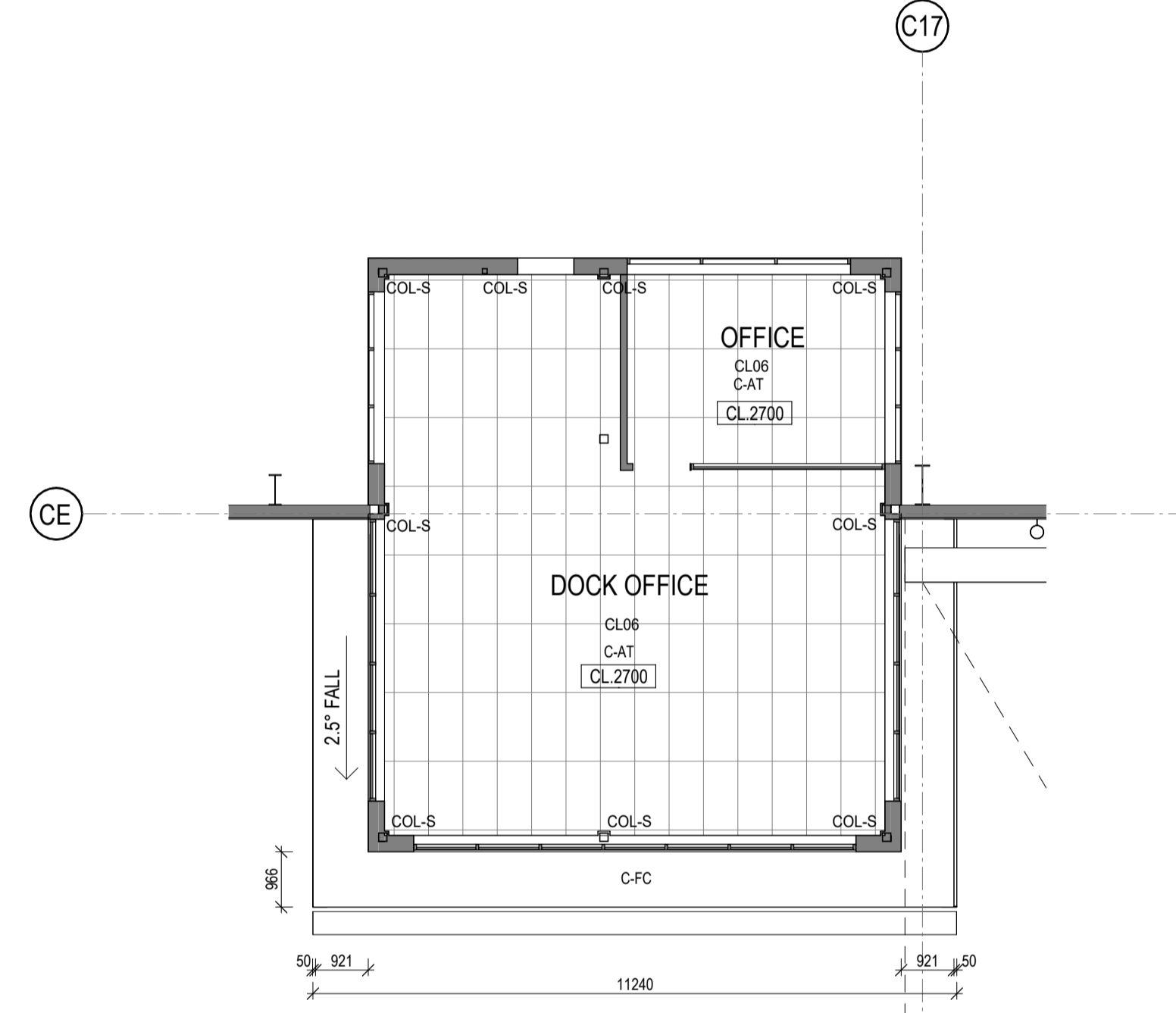

5 4C DOCK OFFICE RCP - LEVEL 1 1 : 100

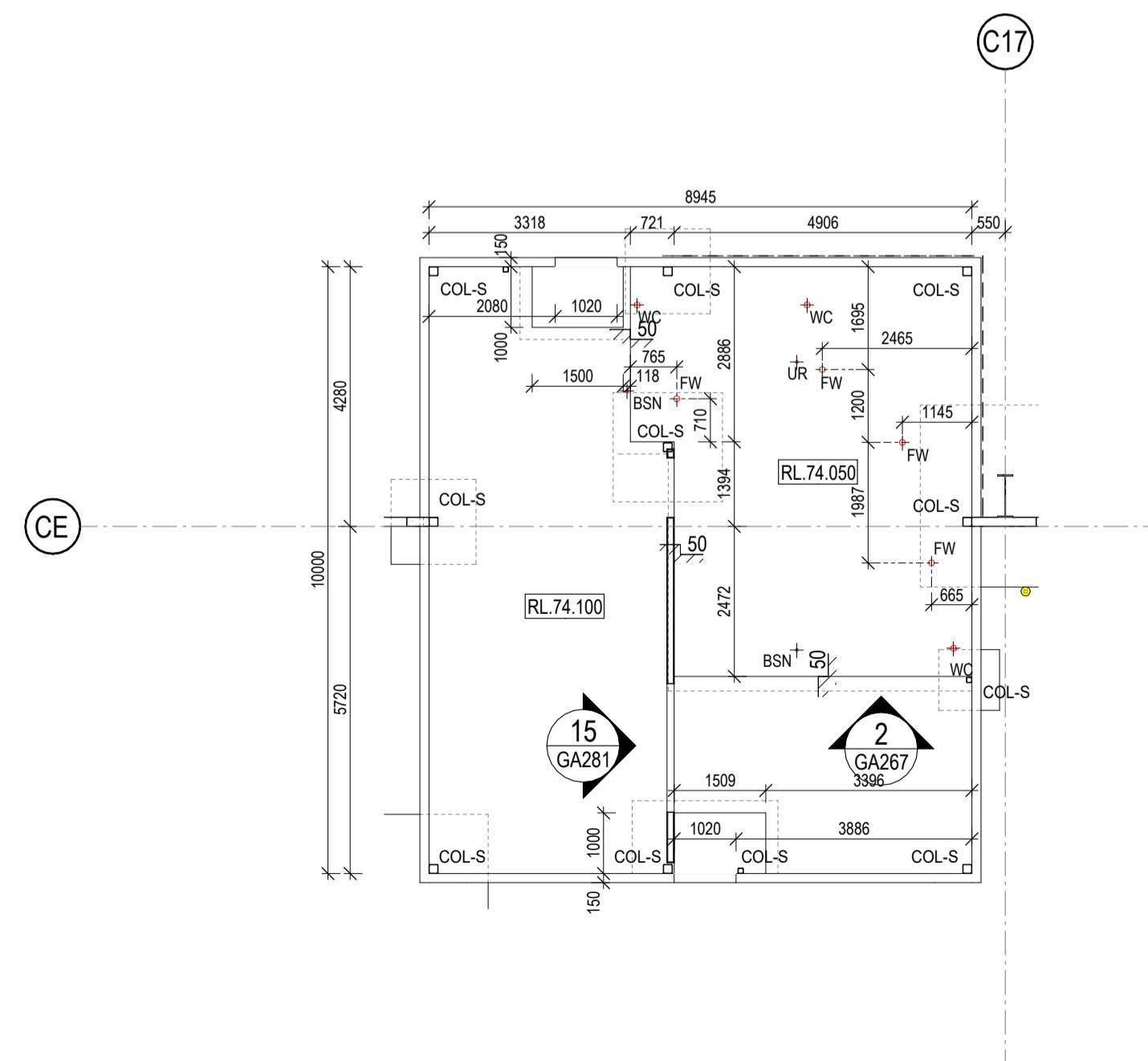

6 4C DOCK OFFICE CONCRETE OUTLINE PLAN - GROUND 1 : 100

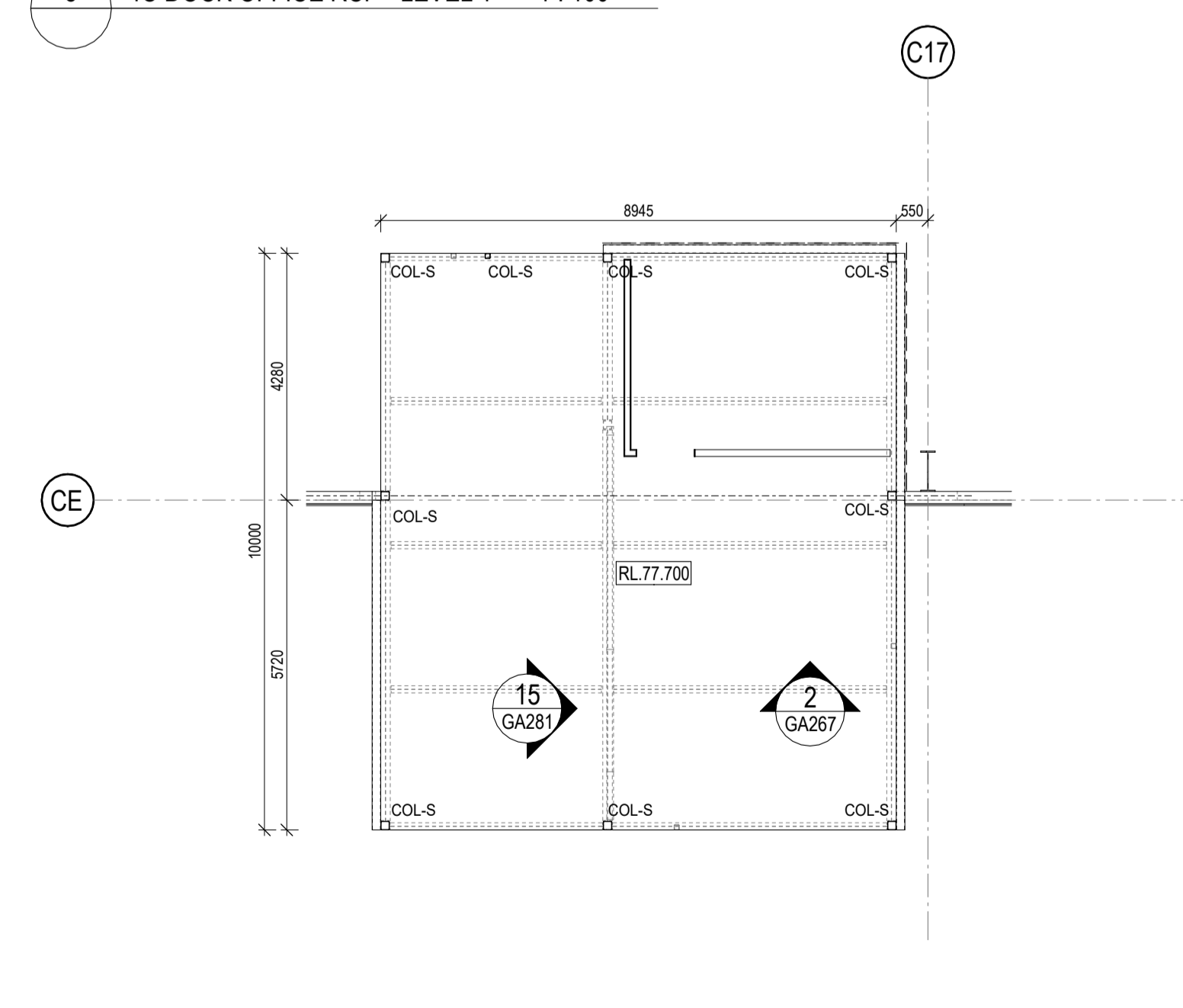

7 4C DOCK OFFICE CONCRETE OUTLINE PLAN - LEVEL 1 1 : 100

**CONSTRUCTION CERTIFICATE**  
 Approved Plans & Specifications relating to:  
 Date Approved: **10 July 2024**  
 Certificate No.: **CC - 2 4 0 8 1**  
**BLACKETT MAGUIRE + GOLDSMITH**

**FOR CONSTRUCTION**

5	ISSUE FOR COCA	29/05/24	THESE DESIGN PLANS & SPECIFICATIONS AND THE COPYRIGHT THEREIN ARE THE PROPERTY OF THE ARCHITECT AND MUST NOT BE USED, REPRODUCED OR COPIED IN ANY MANNER WITHOUT THE WRITTEN PERMISSION OF THIS OFFICE.
3	Furniture moved. Door etc. added.	13/05/24	
4	ISSUED FOR CONSTRUCTION	23/01/24	FIGURES DIMENSIONS TO BE USED IN PREFERENCE TO SCALES. ALL DIMENSIONS TO BE CHECKED ON SITE.
6	Design revised.	21/10/23	
3	ISSUED FOR CONSTRUCTION		
1	Floor wastes coordinated.		
2	ISSUE FOR COCA		
4	DESCRIPTION		

CLIENT	<b>Goodman</b>	BUILDER	<b>Qanstruct</b> Partner of choice	PROJECT NO.	<b>23131</b>
				SCALE	1:100 @ B1
				DATE	29/05/24
				DRAWN	Author
				CHECKED	Checker
				APPROVED	Approver
				DWG NO.	GA225
				REVISION	5

CLIENT	<b>Goodman</b>	BUILDER	<b>Qanstruct</b> Partner of choice	PROJECT NO.	<b>23131</b>
				SCALE	1:100 @ B1
				DATE	29/05/24
				DRAWN	Author
				CHECKED	Checker
				APPROVED	Approver
				DWG NO.	GA225
				REVISION	5

OAKDALE WEST -- LOTS 4C & 4D  
 KEMPS CREEK, NSW  
 TITLE  
**4C DOCK OFFICE PLANS**  
 DATE 29/05/24  
 SCALE 1:100 @ B1  
 DRAWN Author  
 CHECKED Checker  
 APPROVED Approver  
 PROJECT NO. 23131  
 DWG NO. GA225  
 REVISION 5  
 29/05/2024 10:02:55 AM



**CONSTRUCTION CERTIFICATE**  
 Approved Plans & Specifications relating to:  
 Date Approved: **10 July 2024**  
 Certificate No.: **CC - 24081**  
**BLACKETT MAGUIRE + GOLDSMITH**

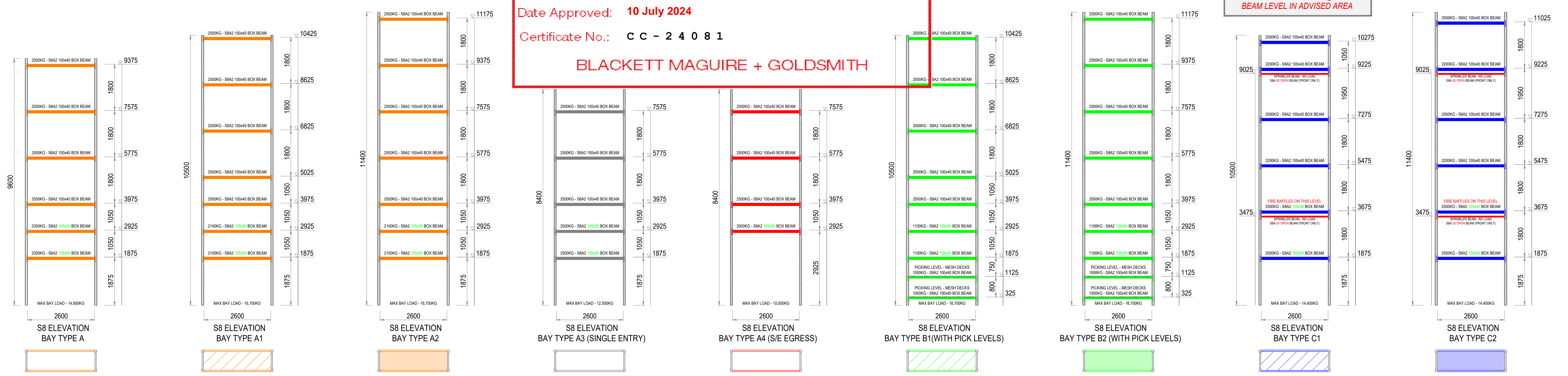

**FIRE BAFFLE POSITIONED @ 3675MM BEAM LEVEL IN ADVISED AREA**

**FIRE BAFFLE POSITIONED @ 3675MM BEAM LEVEL IN ADVISED AREA**

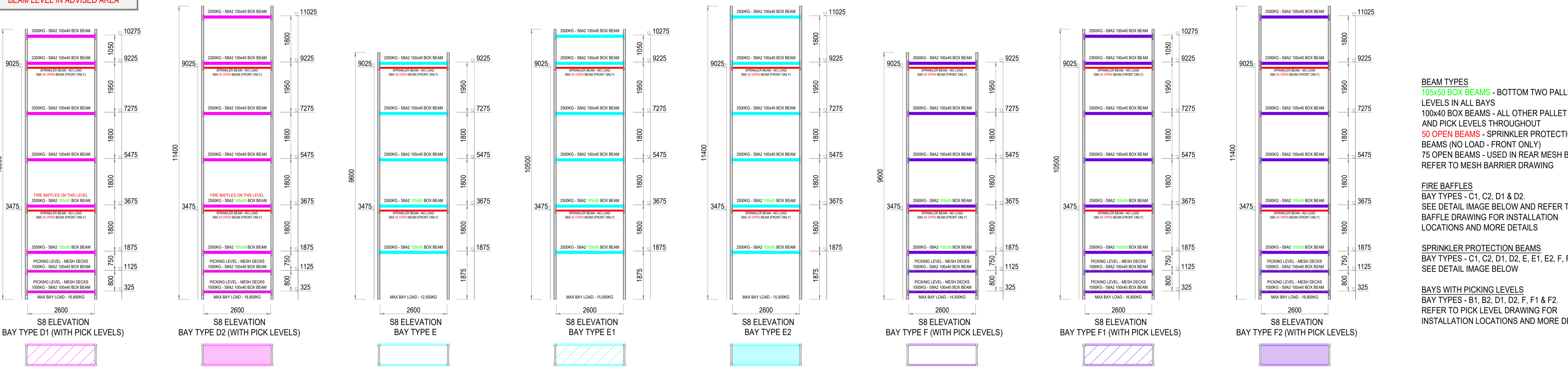

**FIRE BAFFLE POSITIONED @ 3675MM BEAM LEVEL IN ADVISED AREA**

**FIRE BAFFLE POSITIONED @ 3675MM BEAM LEVEL IN ADVISED AREA**

**BEAM TYPES**  
 105x50 BOX BEAMS - BOTTOM TWO PALLET LEVELS IN ALL BAYS  
 100x40 BOX BEAMS - ALL OTHER PALLET LEVELS AND PICK LEVELS THROUGHOUT  
 50 OPEN BEAMS - SPRINKLER PROTECTION BEAMS (NO LOAD - FRONT ONLY)  
 75 OPEN BEAMS - USED IN REAR MESH BARRIER REFER TO MESH BARRIER DRAWING

**FIRE BAFFLES**  
 BAY TYPES - C1, C2, D1 & D2.  
 SEE DETAIL IMAGE BELOW AND REFER TO FIRE BAFFLE DRAWING FOR INSTALLATION LOCATIONS AND MORE DETAILS

**SPRINKLER PROTECTION BEAMS**  
 BAY TYPES - C1, C2, D1, D2, E, E1, E2, F, F1 & F2.  
 SEE DETAIL IMAGE BELOW

**BAYS WITH PICKING LEVELS**  
 BAY TYPES - B1, B2, D1, D2, F, F1 & F2.  
 REFER TO PICK LEVEL DRAWING FOR INSTALLATION LOCATIONS AND MORE DETAILS

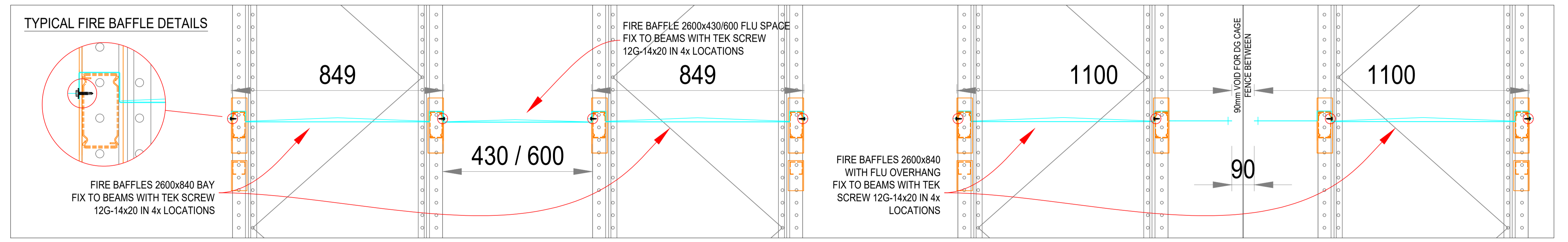
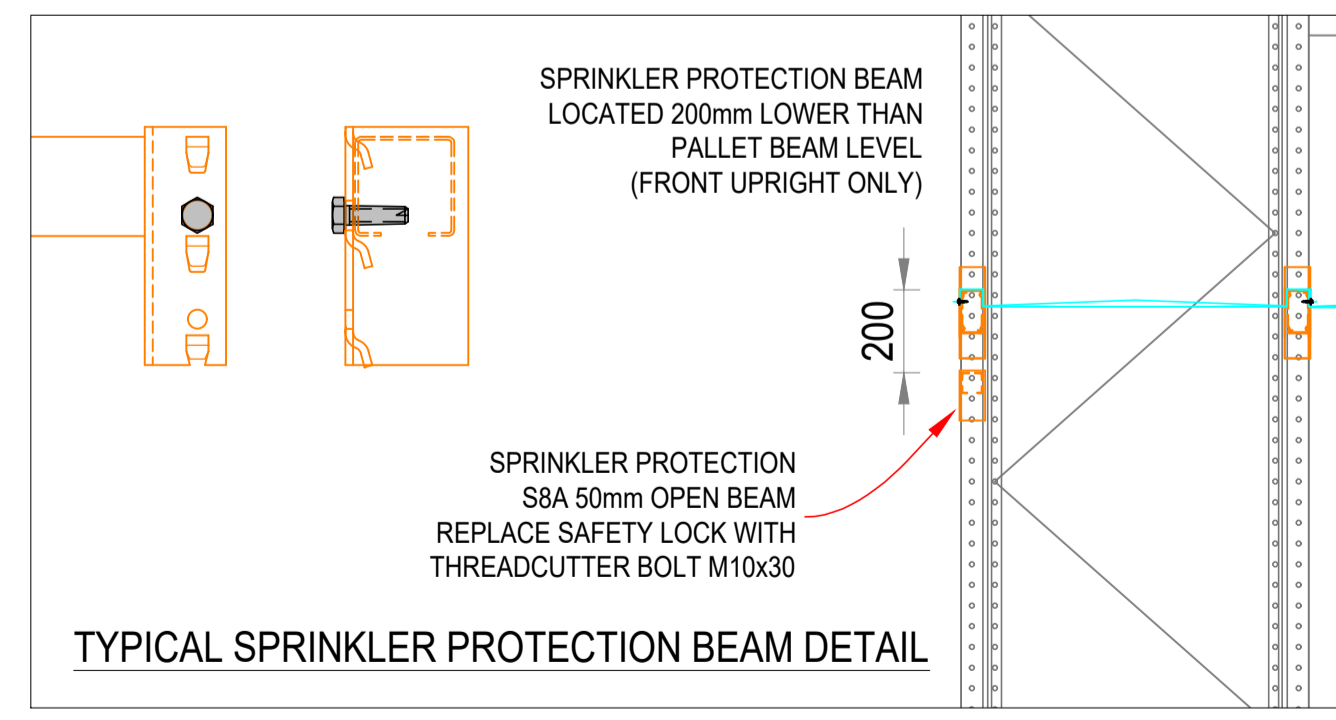

**SHEET**  
 A1

**DESIGN POINT LOAD DATA**

(G + Q) STATIC POINT LOAD -	88.19 kN
(G + Q + Eu) SEISMIC POINT LOAD -	138.73 kN

ISSUE	No.	DATE	In.	COMMENTS
	2	01.03.24	AC	SALES DWG - 3
	1	29.02.24	AC	SALES DWG - 2
	0	23.02.24	AC	SALES DWG - 1

No.	DATE	In.	COMMENTS
5			
4			
3	18.06.24	AC	INSTALL DWG - 3

CLIENT **LINFIX - BEV CHAIN**  
 TITLE **PROPOSED RACKING ELEVATIONS**  
 SITE **KEMPS CREEK, NSW**

AREA SALES MANAGER **DALE MAKIN**  
 T 03 8795 5836 F 03 8795 5899  
 D 03 8795 5831 M 0400 037 586  
 E [dmakin@dexionvictoria.com.au](mailto:dmakin@dexionvictoria.com.au)

DRAWING No. **296568-3**  
 DATE **18.06.24**  
 STATUS **INSTALLATION**  
 DRAWN **AC**





NOTE: ALL UPRIGHTS ARE 500MPa PGAL, SPLICES PGAL & BASEPLATES ORANGE

FRAME 90 POST WITH 5x X BRC SHOWN

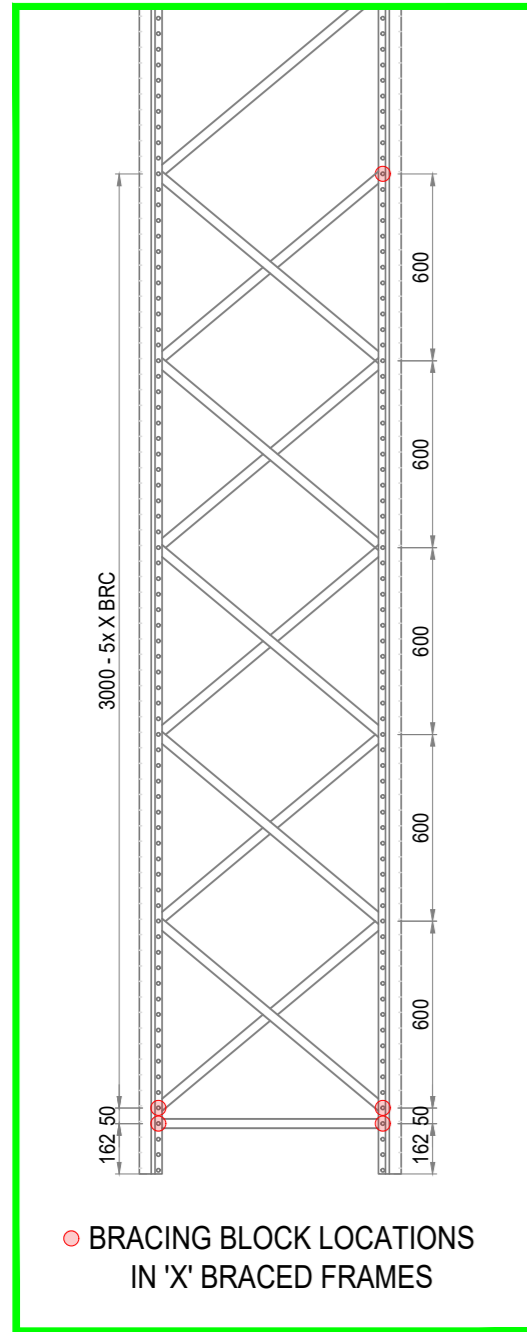

BRACING BLOCK LOCATIONS IN 'X' BRACED FRAMES

90 POST UPRIGHTS (SINGLE ENTRY RUN ALONG WALL ONLY)

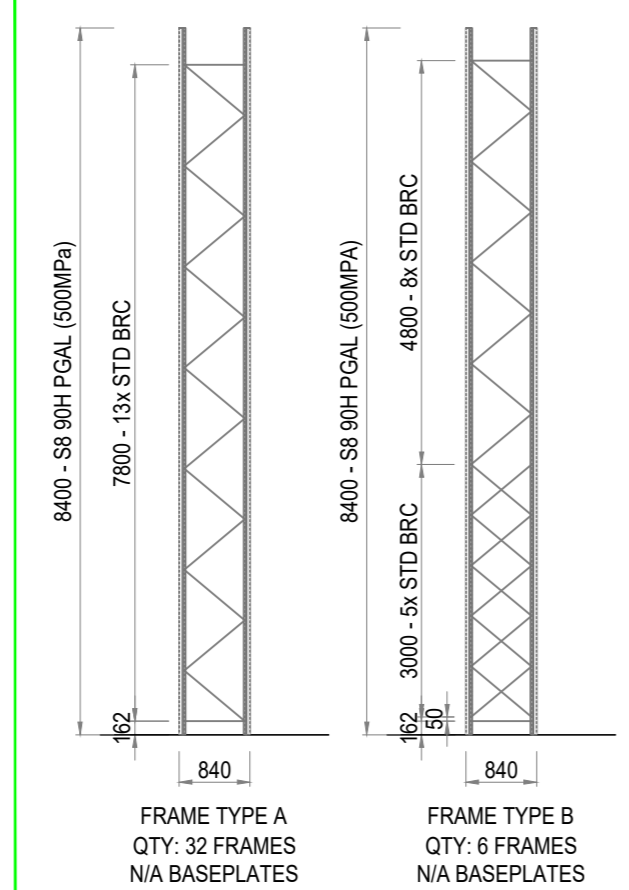

FRAME TYPE A QTY: 6 FRAMES N/A BASEPLATES  
FRAME TYPE B QTY: 6 FRAMES N/A BASEPLATES

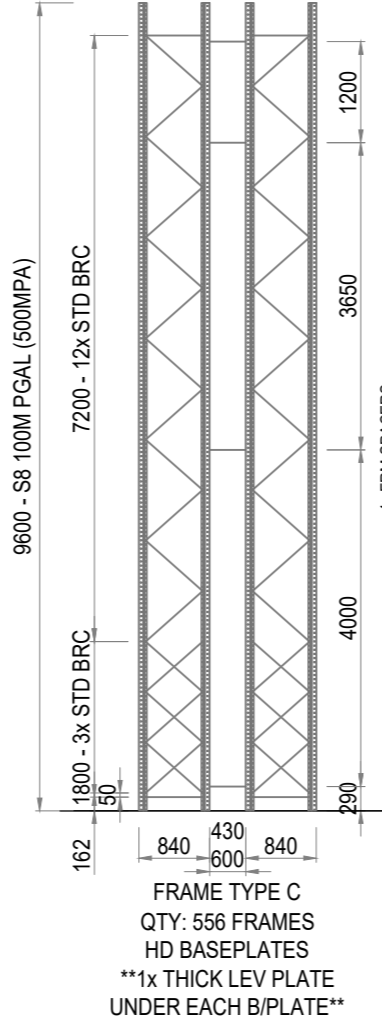

FRAME TYPE C QTY: 556 FRAMES HD BASEPLATES \*\*1x THICK LEV PLATE UNDER EACH B/PLATE\*\*

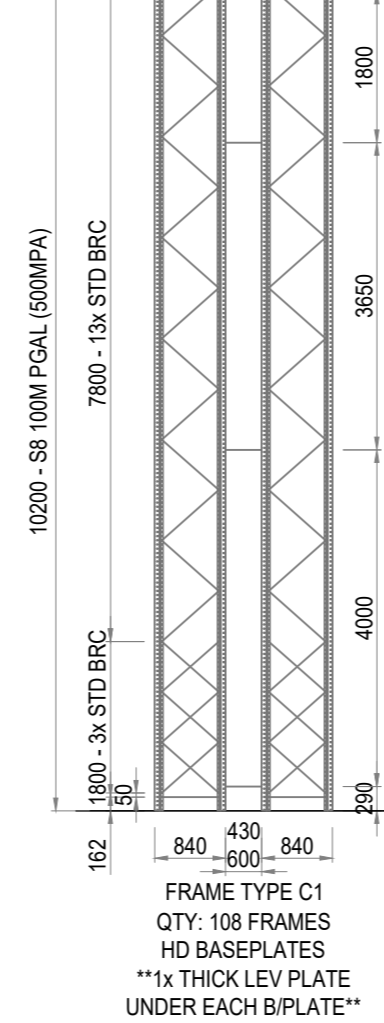

FRAME TYPE C1 QTY: 108 FRAMES HD BASEPLATES \*\*1x THICK LEV PLATE UNDER EACH B/PLATE\*\*

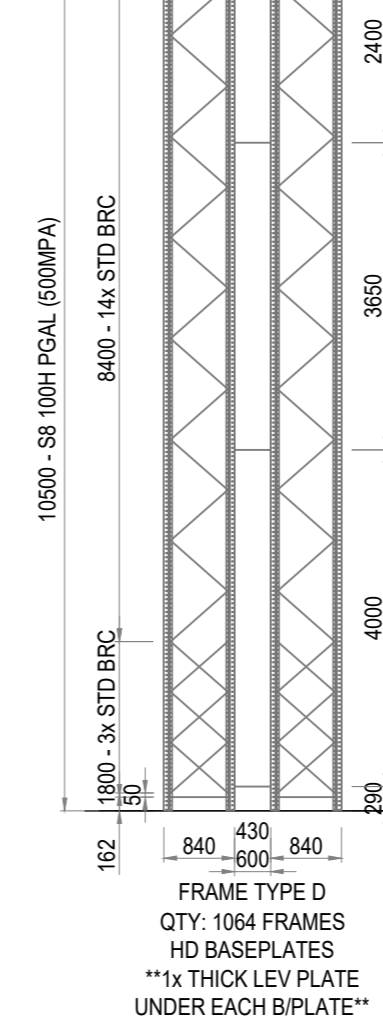

FRAME TYPE D QTY: 1064 FRAMES HD BASEPLATES \*\*1x THICK LEV PLATE UNDER EACH B/PLATE\*\*

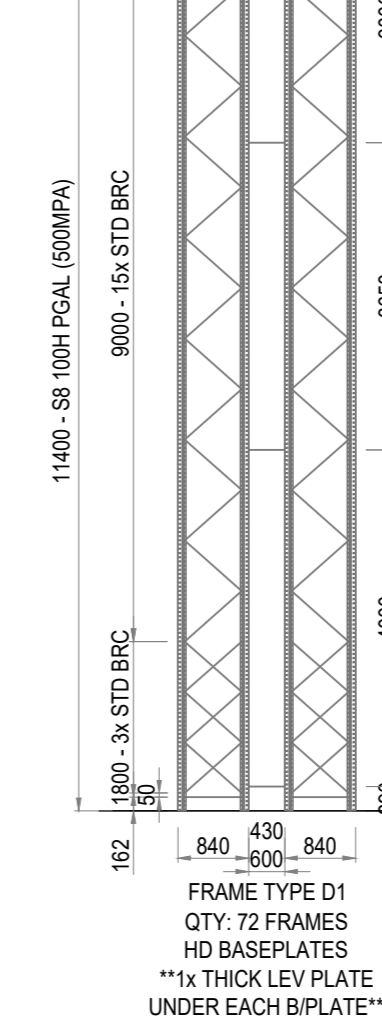

FRAME TYPE D1 QTY: 72 FRAMES HD BASEPLATES \*\*1x THICK LEV PLATE UNDER EACH B/PLATE\*\*

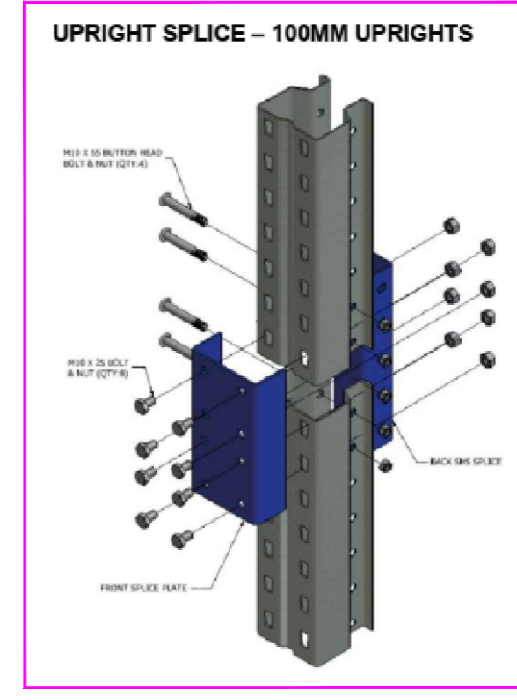
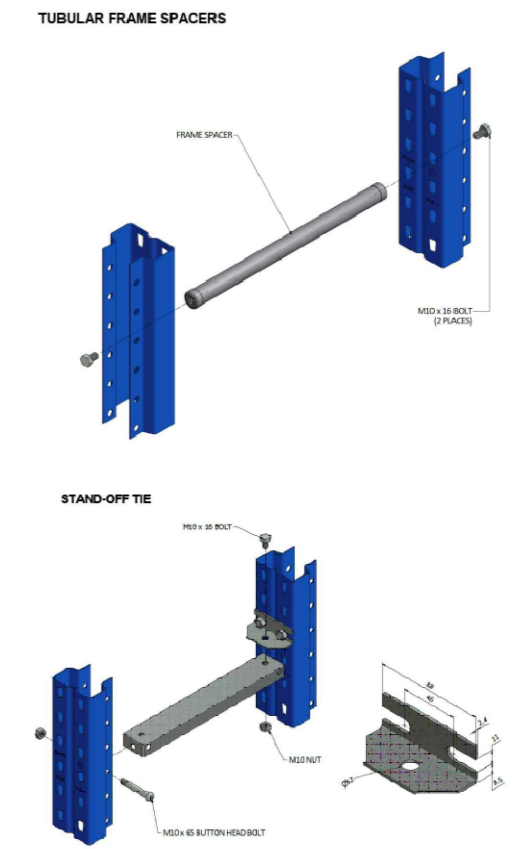

SPICED UPRIGHT LOCATIONS

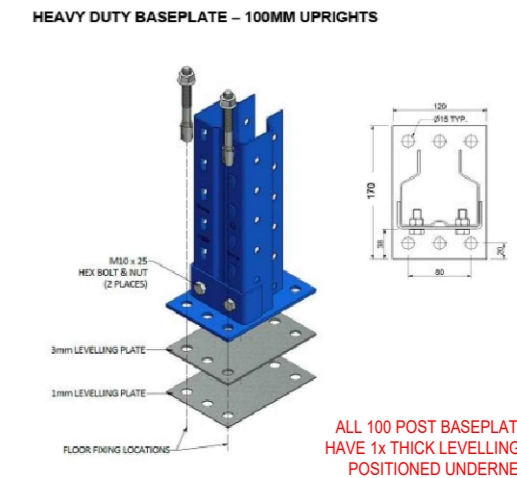
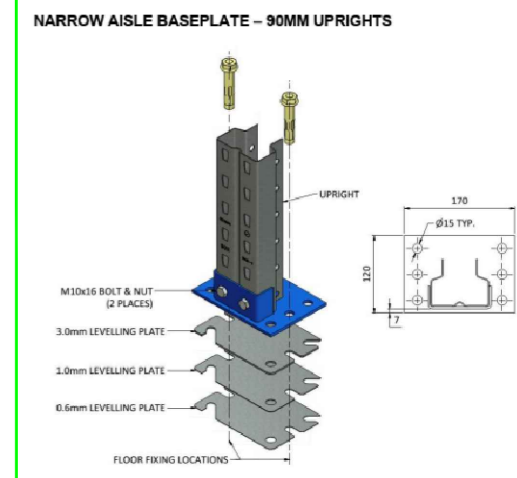

ALL 100 POST BASEPLATES TO HAVE 1x THICK LEVELLING PLATE POSITIONED UNDERNEATH

**CONSTRUCTION CERTIFICATE**  
Approved Plans & Specifications relating to:  
Date Approved: 10 July 2024  
Certificate No.: CC - 24081  
BLACKETT MAGUIRE + GOLDSMITH

FRAME 100 POST WITH 3x X BRC SHOWN

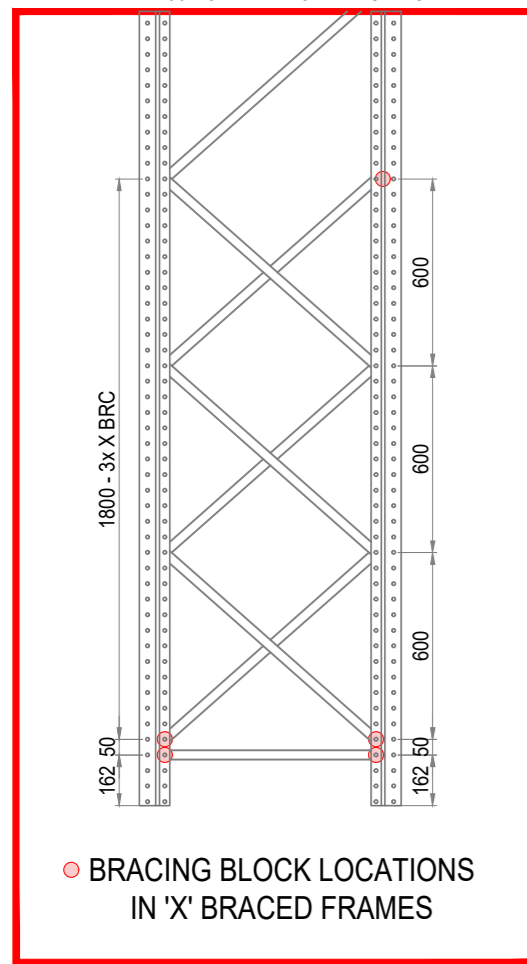

BRACING BLOCK LOCATIONS IN 'X' BRACED FRAMES

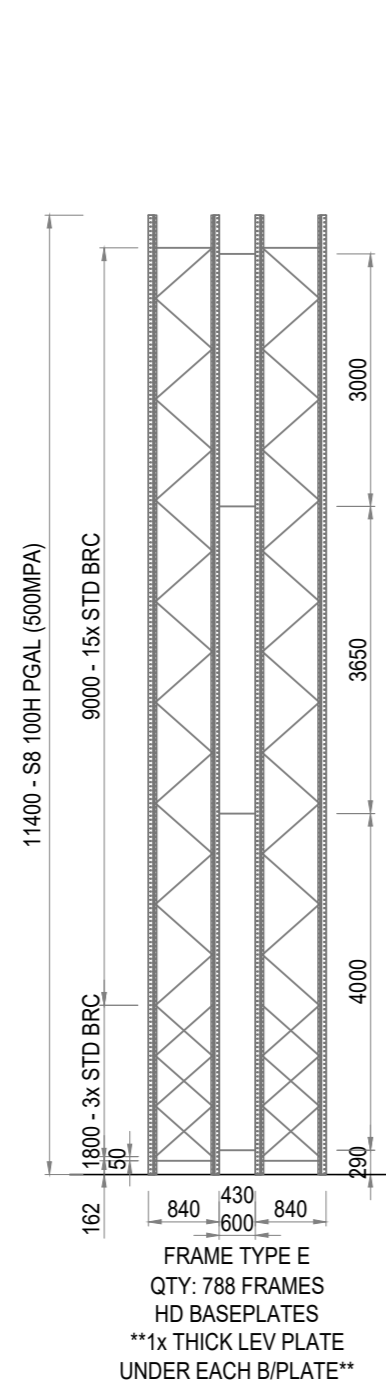

FRAME TYPE E QTY: 788 FRAMES HD BASEPLATES \*\*1x THICK LEV PLATE UNDER EACH B/PLATE\*\*

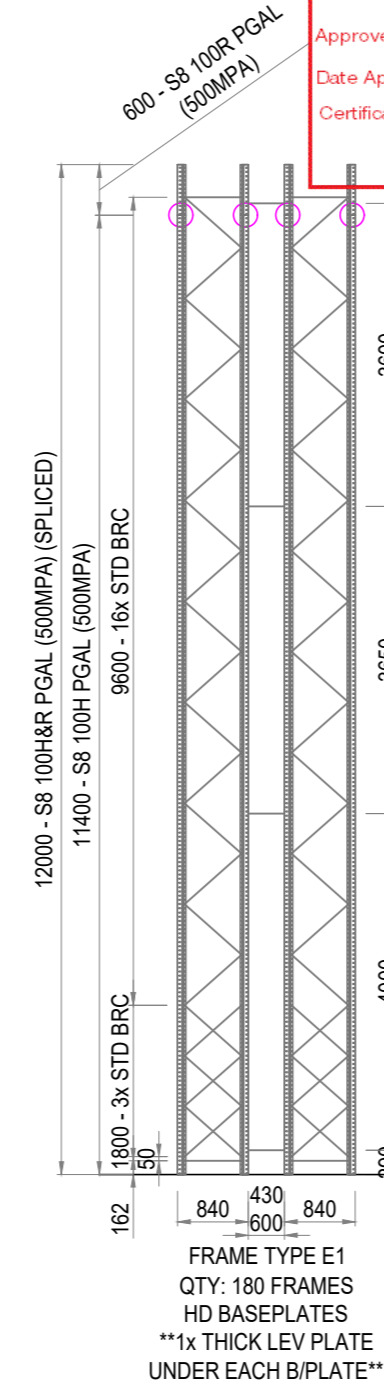

FRAME TYPE E1 QTY: 180 FRAMES HD BASEPLATES \*\*1x THICK LEV PLATE UNDER EACH B/PLATE\*\*

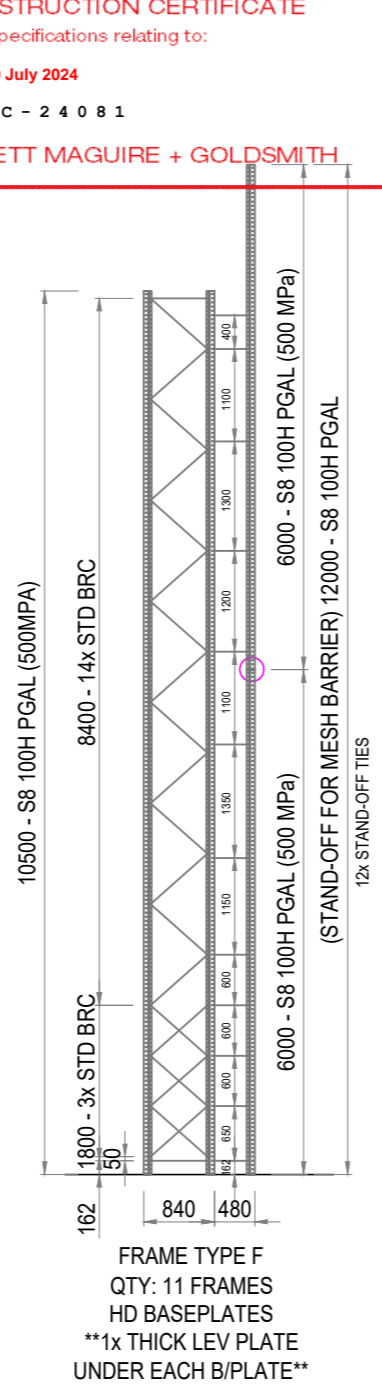

FRAME TYPE F QTY: 11 FRAMES HD BASEPLATES \*\*1x THICK LEV PLATE UNDER EACH B/PLATE\*\*

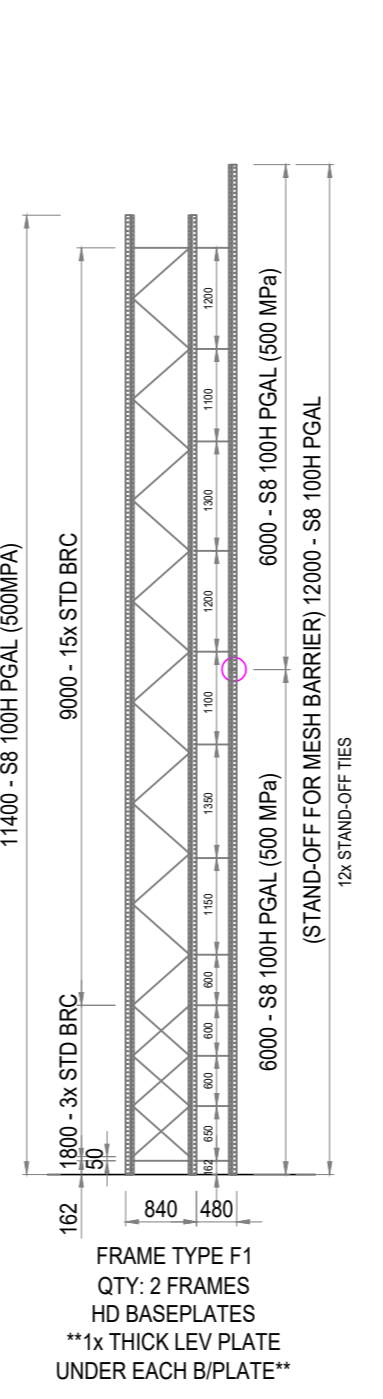

FRAME TYPE F1 QTY: 2 FRAMES HD BASEPLATES \*\*1x THICK LEV PLATE UNDER EACH B/PLATE\*\*

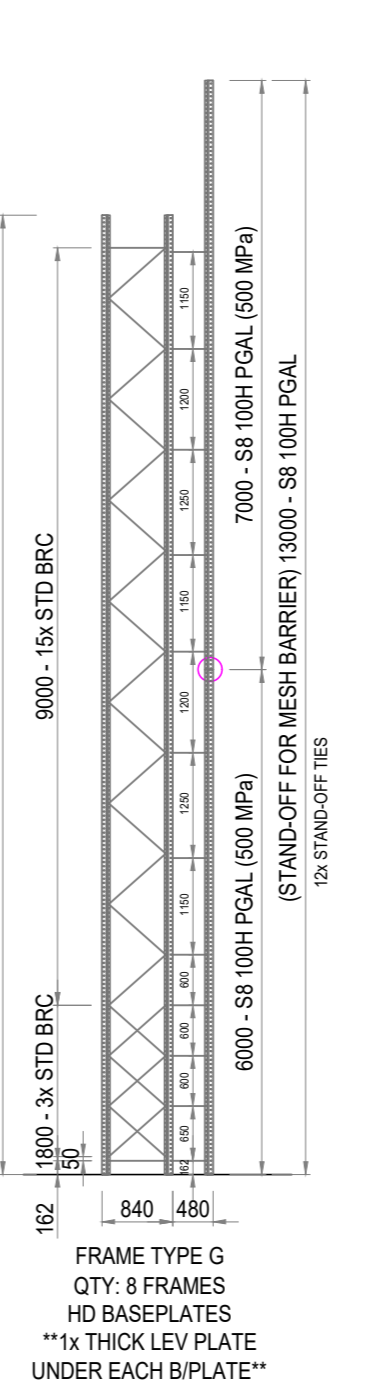

FRAME TYPE G QTY: 8 FRAMES HD BASEPLATES \*\*1x THICK LEV PLATE UNDER EACH B/PLATE\*\*

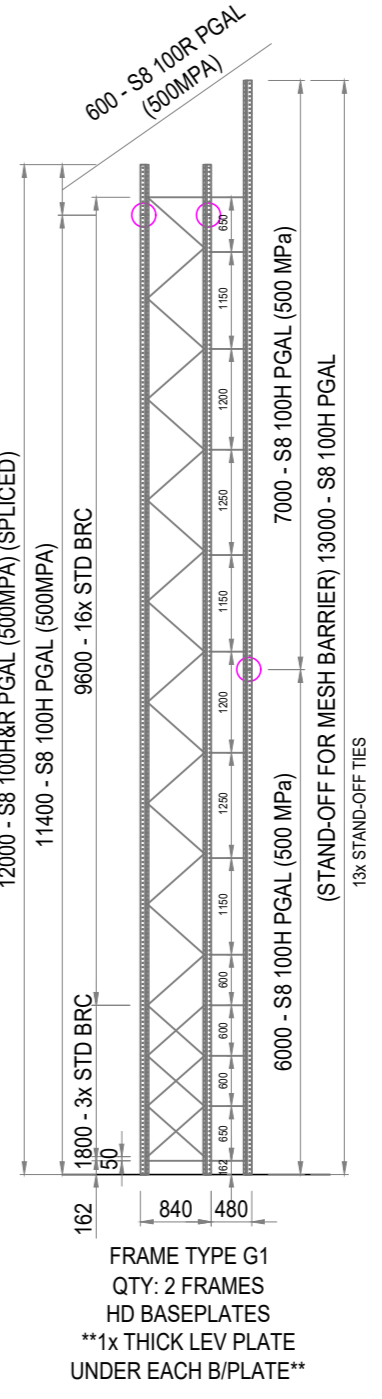

FRAME TYPE G1 QTY: 2 FRAMES HD BASEPLATES \*\*1x THICK LEV PLATE UNDER EACH B/PLATE\*\*

SHEET

A2

COPYRIGHT RESERVED 2023  
THIS DRAWING IS THE PROPERTY OF  
DEXION HOLDINGS PTY LTD.  
IT MUST NOT BE COPIED WITHOUT  
PRIOR WRITTEN CONSENT AND MUST  
BE RETURNED ON REQUEST. THE  
INFORMATION SHOWN ON IT IS TO BE  
REGARDED AS CONFIDENTIAL AND MUST  
NOT BE DISCLOSED TO ANY THIRD PARTY.

DESIGN POINT LOAD DATA

(G + Q) STATIC POINT LOAD - 88.19 kN  
(G + Q + E<sub>u</sub>) SEISMIC POINT LOAD - 138.73 kN

ISSUE	No.	DATE	In.	COMMENTS	No.	DATE	In.	COMMENTS
	2				5			
	1				4			
	0	18.06.24	AC	INSTALLATION DWG - 3	3			

CLIENT	LINFOX AUSTRALIA
TITLE	FRAME ASSEMBLY DETAILS
SITE	KEMPS CREEK, NSW

AREA SALES MANAGER	DALE MAKIN
T	03 8795 5836
F	03 8795 5899
D	03 8795 5831
M	0400 037 586
E	dmakin@dexionvictoria.com.au

DRAWING No.	296568-3
DATE	18.06.24
STATUS	INSTALLATION
DRAWN	AC





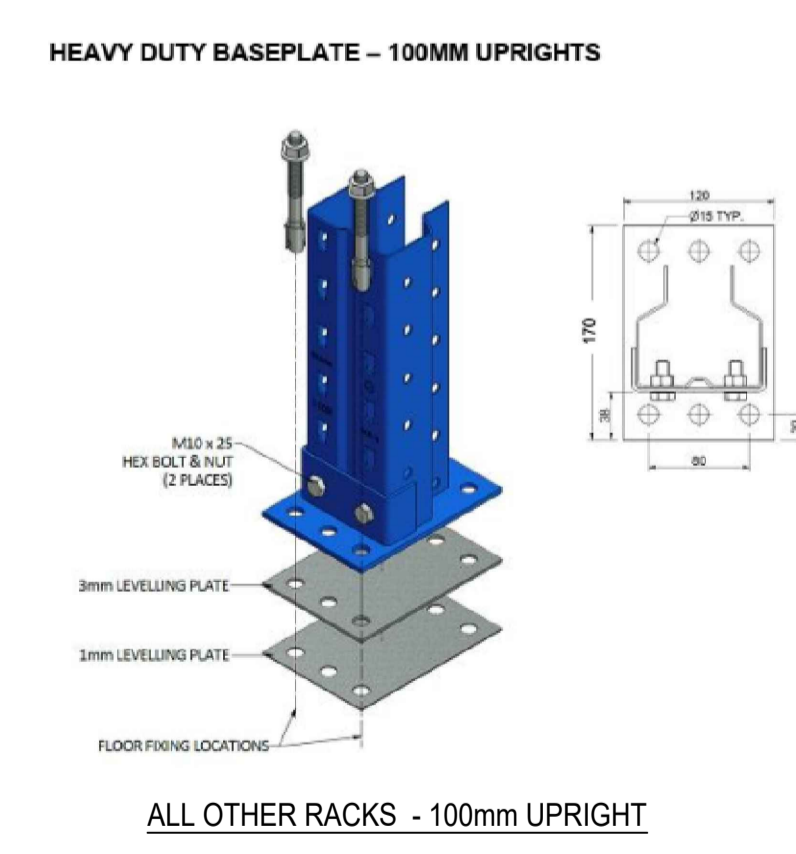
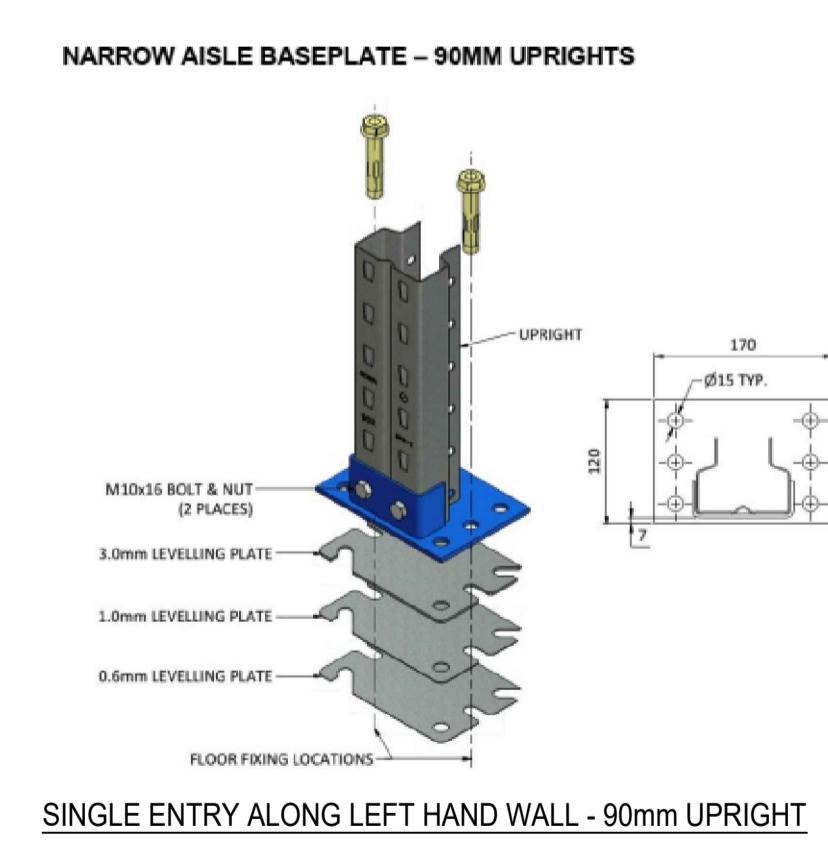
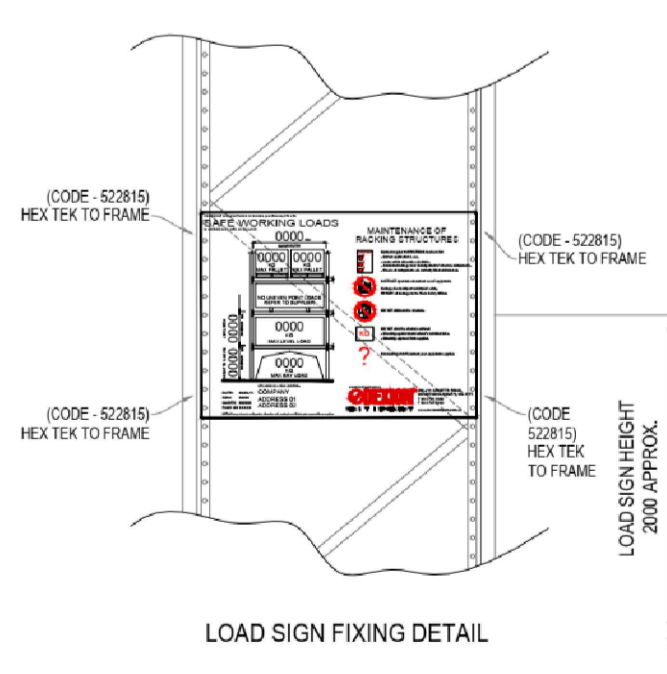
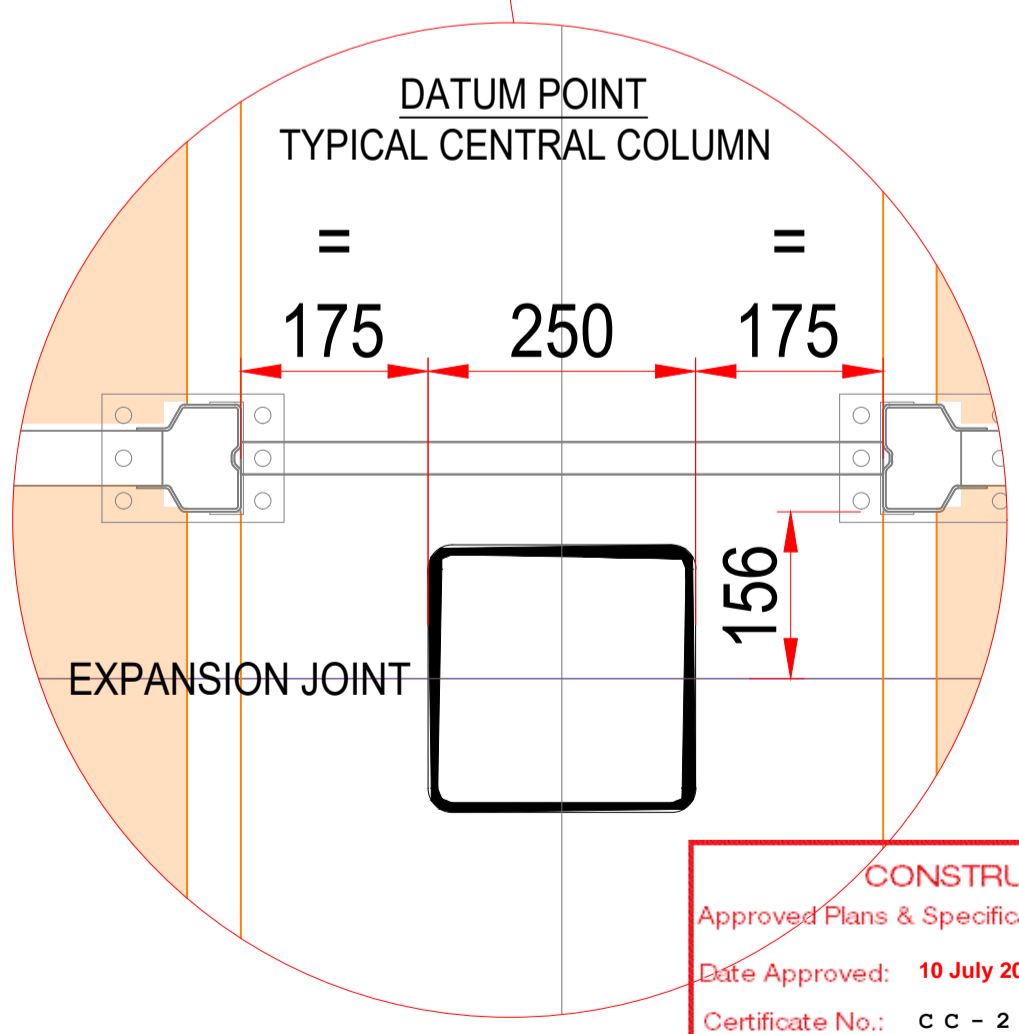
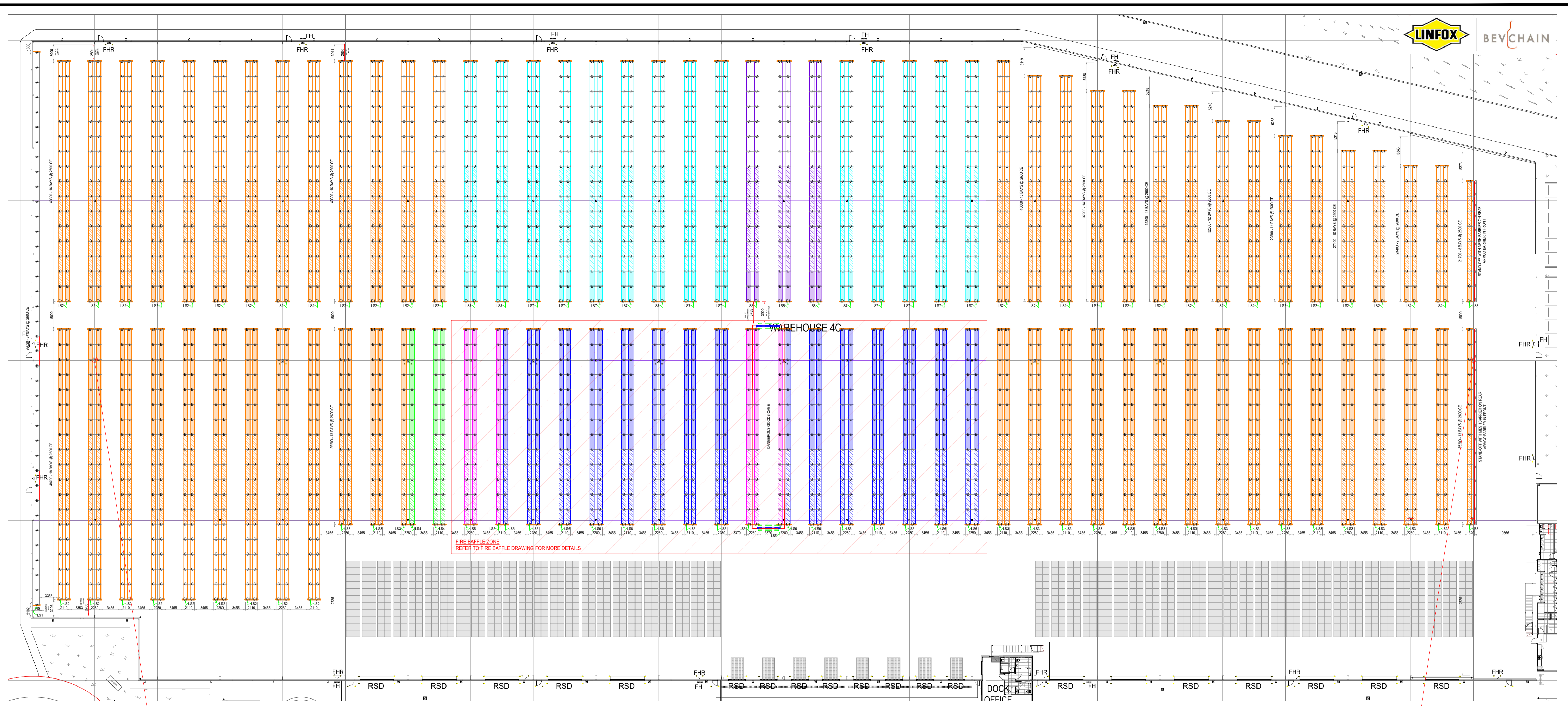

**POINT LOAD DETAILS**

(G+Q) STATIC POINT LOAD = 88.19 KN  
 (G+Q+Eu) SEISMIC POINT LOAD = 138.73 KN

SIZE OF DEXION NARROW AISLE BASEPLATE = 170mm WIDE X 120mm DEEP  
 ANCHOR TYPE - SCREW-IN ANCHOR - M10 X 100mm (2 PER B/PLATE - SEISMIC C1 APPROVED)

SIZE OF DEXION HEAVY DUTY BASEPLATE = 120mm WIDE X 170mm DEEP  
 ANCHOR TYPE - SCREW-IN ANCHOR - M10 X 100mm (2 PER B/PLATE - SEISMIC C1 APPROVED)

Designed According to AS4084-2023

Location - Kemps Creek, NSW  
 Soil Type - C  
 Hazard Factor - 0.08  
 ψM - 0.8 (weak)  
 ψA - 1.0 (maximum)

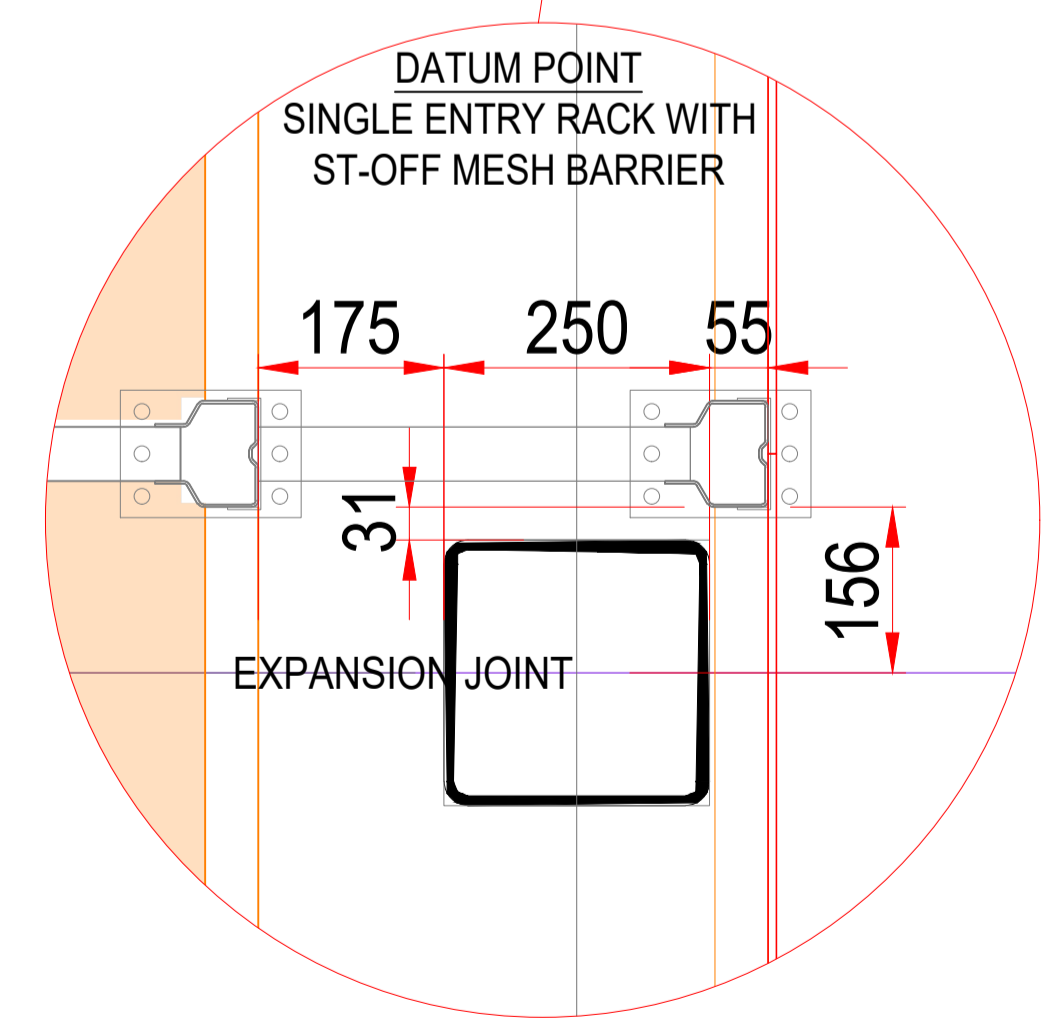

**CONSTRUCTION CERTIFICATE**  
 Approved Plans & Specifications relating to:  
 Date Approved: 10 July 2024  
 Certificate No.: CC - 24081  
**BLACKETT MAGUIRE + GOLDSMITH**

REFER TO BAY ELEVATIONS, FRAME ASSEMBLY AND OTHER RELEVANT DRAWINGS FOR FURTHER DETAILS

**DESIGN POINT LOAD DATA**

(G + Q) STATIC POINT LOAD -	88.19 kN
(G + Q + Eu) SEISMIC POINT LOAD -	138.73 kN

ISSUE	No.	DATE	In.	COMMENTS
	2	01.03.24	AC	SALES DWG - 3
	1	29.02.24	AC	SALES DWG - 2
	0	23.02.24	AC	SALES DWG - 1

ISSUE	No.	DATE	In.	COMMENTS
	5			
	4			
	3	18.06.24	AC	TSR DWG - 3

CLIENT	LINFOX - BEV CHAIN
TITLE	PROPOSED RACKING LAYOUT - TSR
SITE	KEMPS CREEK, NSW

AREA SALES MANAGER	DALE MAKIN
T	03 8795 5836
F	03 8795 5899
D	03 8795 5831
M	0400 037 586
E	dmakin@dexionvictoria.com.au

DRAWING No.	296568-3 TSR
DATE	18.06.24
STATUS	TSR
DRAWN	AC