

# PROPOSED SITE PLAN – OPTION 1C

| AREA SCHEDULE              | SQM           |
|----------------------------|---------------|
| <b>Site area</b>           | <b>62,509</b> |
| <b>TENANCY 1</b>           |               |
| Warehouse                  | 9,428         |
| Office ground              | 41            |
| Office first               | 350           |
| Dock office                | 50            |
| <b>Total</b>               | <b>9,869</b>  |
| <b>TENANCY 2</b>           |               |
| Warehouse                  | 11,041        |
| Office ground              | 41            |
| Office first               | 350           |
| Dock office                | 50            |
| <b>Total</b>               | <b>11,482</b> |
| <b>TENANCY 3</b>           |               |
| Warehouse                  | 6,989         |
| Office ground              | 41            |
| Office first               | 350           |
| Dock office                | 50            |
| <b>Total</b>               | <b>7,430</b>  |
| <b>TENANCY 4</b>           |               |
| Warehouse                  | 9,428         |
| Office ground              | 41            |
| Office first               | 350           |
| Dock office                | 50            |
| <b>Total</b>               | <b>9,869</b>  |
| <b>Total building area</b> | <b>38,650</b> |
| Awning area                | 4,373         |
| Hardstand area             | 15,026        |
| Carpark area               | 5,685         |
| Car spaces (inc. 4 PWD)    | 202           |

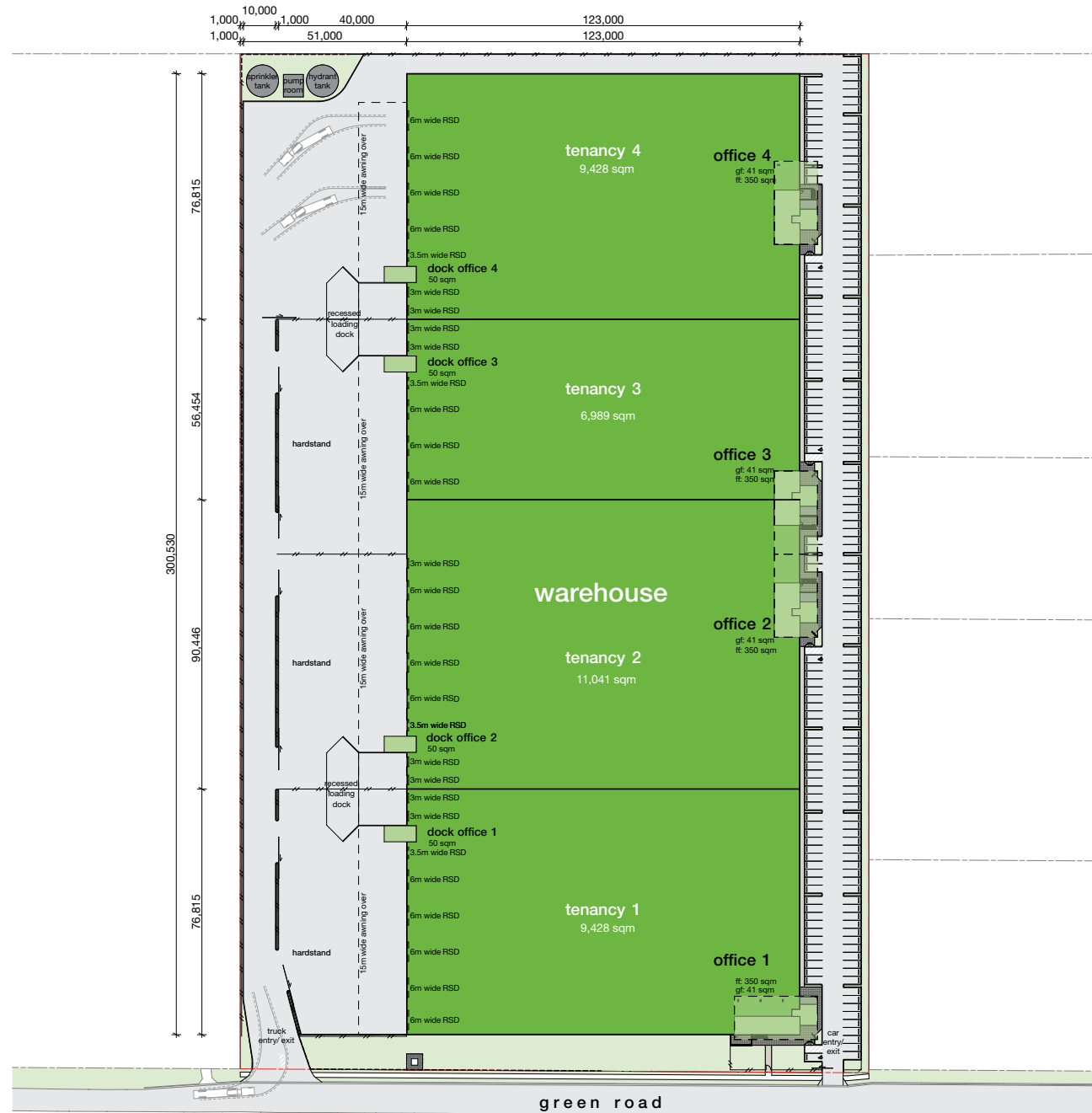

■ FOR LEASE